

VAN<sup>®</sup>





# MADE FOR SAILORS

A Vaan is made for sailors. For the sensation of the water and the wind. It's meant to excite and explore. With twin aft helm stations, good upwind performance, a lower boom, this cat is made for sailors.







## ARRIVE IN STYLE

With its minimalist styling and smart design solutions, a Vaan is both alluring and ergonomical. Easy to handle and robust. The warm, natural interior creates a light and balanced atmosphere. A perfect place to enjoy a good time, and arrive in style.



The image shows the interior of a modern yacht saloon at night. The space is illuminated by warm, recessed ceiling lights. On the left, there is a large, L-shaped white leather sofa with a dark wood table in front of it. A glass of red wine and a magazine are on the table. In the center, a small television is mounted on a black pillar, displaying a scene from the TV show 'Undercover'. To the right, there is a modern kitchen area with white cabinetry and a stainless steel sink. Large wrap-around windows provide a panoramic view of a dark lake and mountains at night. The floor is made of light-colored wood planks.

# HOME AWAY FROM HOME

In the evening, when lights are dimming, the saloon provides a spectacular view of the surroundings. The wrap-around windows give a great sense of freedom and transparency, with all the coziness you want from a home.





## BEDROOM WITH A VIEW

The aft owners bedroom has a comfortable full size bed that has beautiful wide views to the side, rear and top. Plenty of storage on the side of the bed and closet space for first essentials. A warm and private space where you can just drift away.



## THAT WALK-IN FEELING

A Vaan is all about space, and no place makes that more clear than the walk-in closet in both hulls.

The tall closet space on the right hold enough cloths to spend months away from home, and buy some new ones along the way. The optional dresser on the left gives you extra drawers for your accessories.





## A TRUE BATHROOM

The forward cabin in the owners hull holds a superior bathroom with a spacious shower. The mirror slides sideways to open a cabinet and three large drawers and shelves give you all the storage you need.





An aerial photograph of a sailboat with dark sails sailing on a vast body of water. To the right of the boat is a large, rocky island covered in dense green forest. The water is a mix of deep blue and lighter, shimmering areas. In the distance, more islands and a hazy horizon are visible under a soft sky.

## OUR MISSION: SAIL THE PLANET

We believe that living a luxury life and protecting the earth can, and should, go hand in hand. This is why we make exciting luxury sailing yachts that do not harm the planet.

#SAILTHEPLANET





## RECYCLED ALUMINIUM

The design of every Vaan is based on circular principles from the start. It is mostly made of recyclable materials and it is almost completely recyclable itself.

The hull is made of more than 60% recycled aluminium like old window frames, traffic signs and license

plates. Some parts contain even more than 85% reused materials.

Aluminium also has an excellent track record for its strength and safety. It makes the hull very rigid, which means no 'cracking' noises inside. And of course it has a great look.



# CIRCULAR MATERIALS

We are committed to use only the best, sustainable materials. The hull is made of recycled aluminium and for the interior the finest sustainable materials are used: lyocell as an alternative for silk, a plant-based alternative for leather made of pineapple leaves, cork decking, linen, and FSC certified wood. This makes a Vaan not only 'circular', it also creates a warm, cosy atmosphere. As it turns out, the 'fair' material is usually also the most refined.

#ITSONLYNATURAL #CIRCULARMATERIALS #SUSTAINABLELUXURY  
#SAILING #RECYCLEDALUMINIUM #ALLELECTRIC #SOLARENERGY  
#BIOBASED #LOWIMPACT #TOGETHER #SAILTHEPLANET

# ALL ELECTRIC

Fitting our 'Sail The Planet' mission, a Vaan is all-electric, from induction cooking to electric propulsion. The large or extra large battery banks are charged from the solar panels, the hydro-generating motors, or the wind. A back-up generator can be added to the energy mix to provide extra assurance on longer journeys.

Not only is all-electric more sustainable, it also saves space and eliminates smells, noises and vibrations.





# THE VAAN RANGE

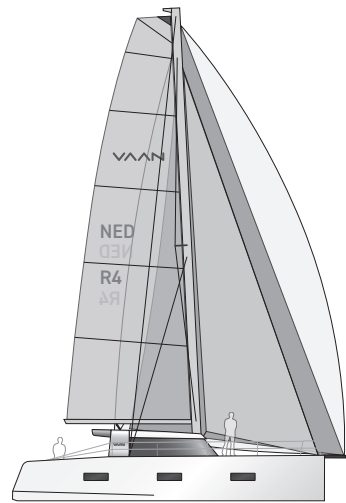

R4

LOA: 42ft/12.80m  
BEAM : 7.06m

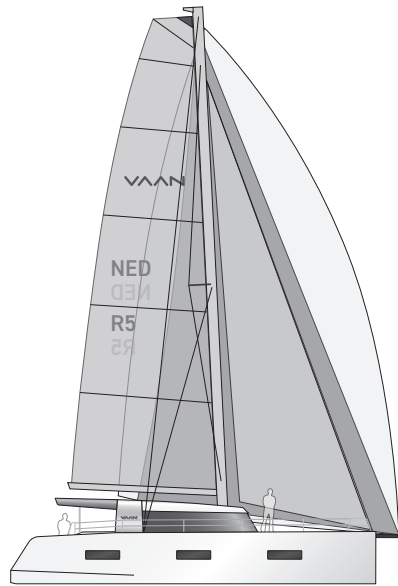

R5

LOA: 49ft/14.95m  
BEAM : 7.99m

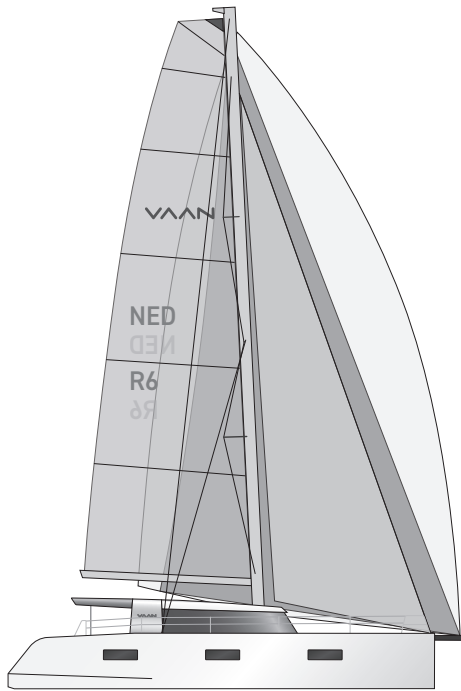

R6

LOA: 58ft/17.68m  
BEAM : 9.03m

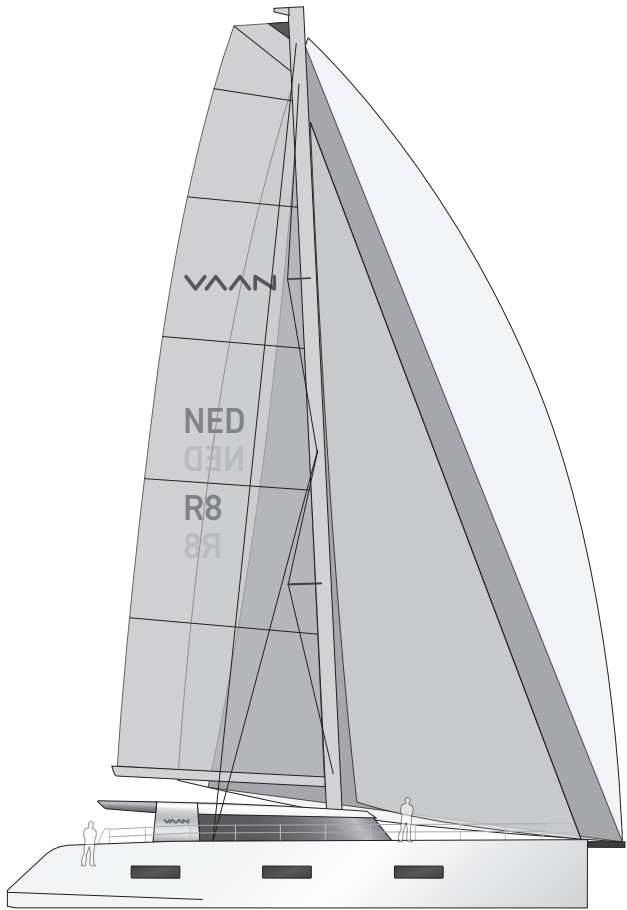

R8

LOA: 78ft/23.80m  
BEAM : 11.00m



VT2250

SOMAC107278  
Q180356\_BN45



A large catamaran with a white hull and black sails is sailing on a blue sea under a clear sky. The boat is viewed from a side-on perspective, showing its wide beam and the large, dark sails. Two people are visible on the deck near the cockpit.

## THE ULTIMATE DECK SALOON

The R4 is designed for sailors who are looking for more space than a monohull offers. The cockpit and saloon are at the same level, and there is very little heeling.

Your friends and family can enjoy all the comfort and luxury, while you are at the helm enjoying their company.

# R4





## THE RIGHT HELM POSITION

As a helmsman you want to be at the back of the cockpit. The large, open transom of the R4 connects you to the water that rushes underneath.

It gives you a spectacular sailing sensation. Much like a monohull but without the heeling, and faster. And because of the dual helm positions, you can always be sheltered and safe from the elements.





# CAT CABRIOLET

Unlike most cats, the Vaan R4 does not have a large, fixed roof all over the cockpit. Instead, we created a bimini that can be installed and removed in a matter of minutes.

People in the cockpit and at the helm can be protected from the sun when desired. But for colder regions, steering in the sun is also possible. It makes the R4 great for going south, as well as for a trip up north.





## THE SALOON LIVING ROOM

The saloon has a bright, warm and welcoming feel to it. The modern and functional kitchen is light yet solid and offers all the amenities to really enjoy some good cooking.



## SPACE & STORAGE

The R4 port-side owners hull offers 4 generous full width and depth closets to store your clothes. The optional dresser offers additional drawers for your accessories. The hallway is intentionally left as open as possible. Because as we all know, space and freedom to move is the true luxury.





# COCKPIT & SALOON

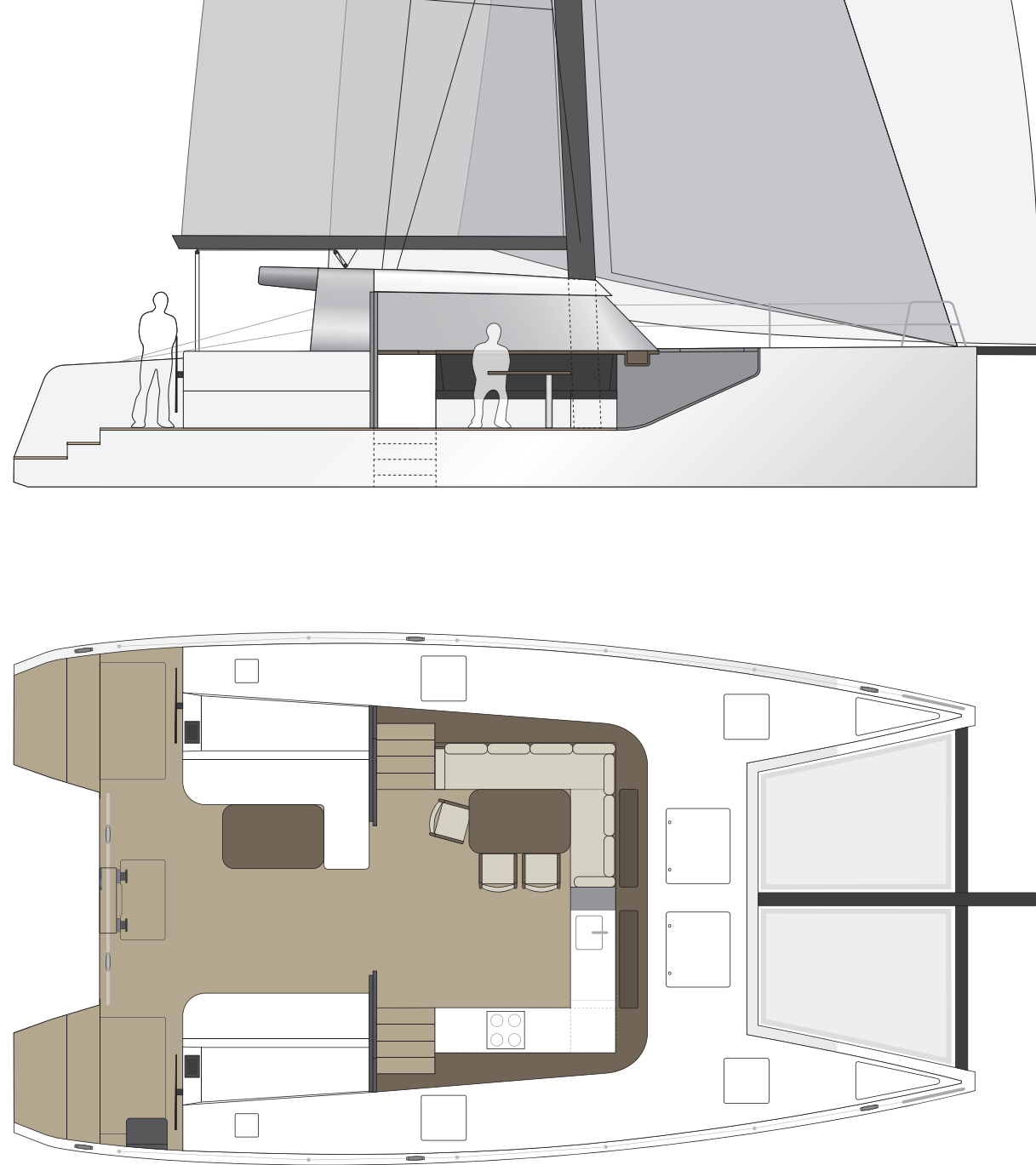

# HULLS

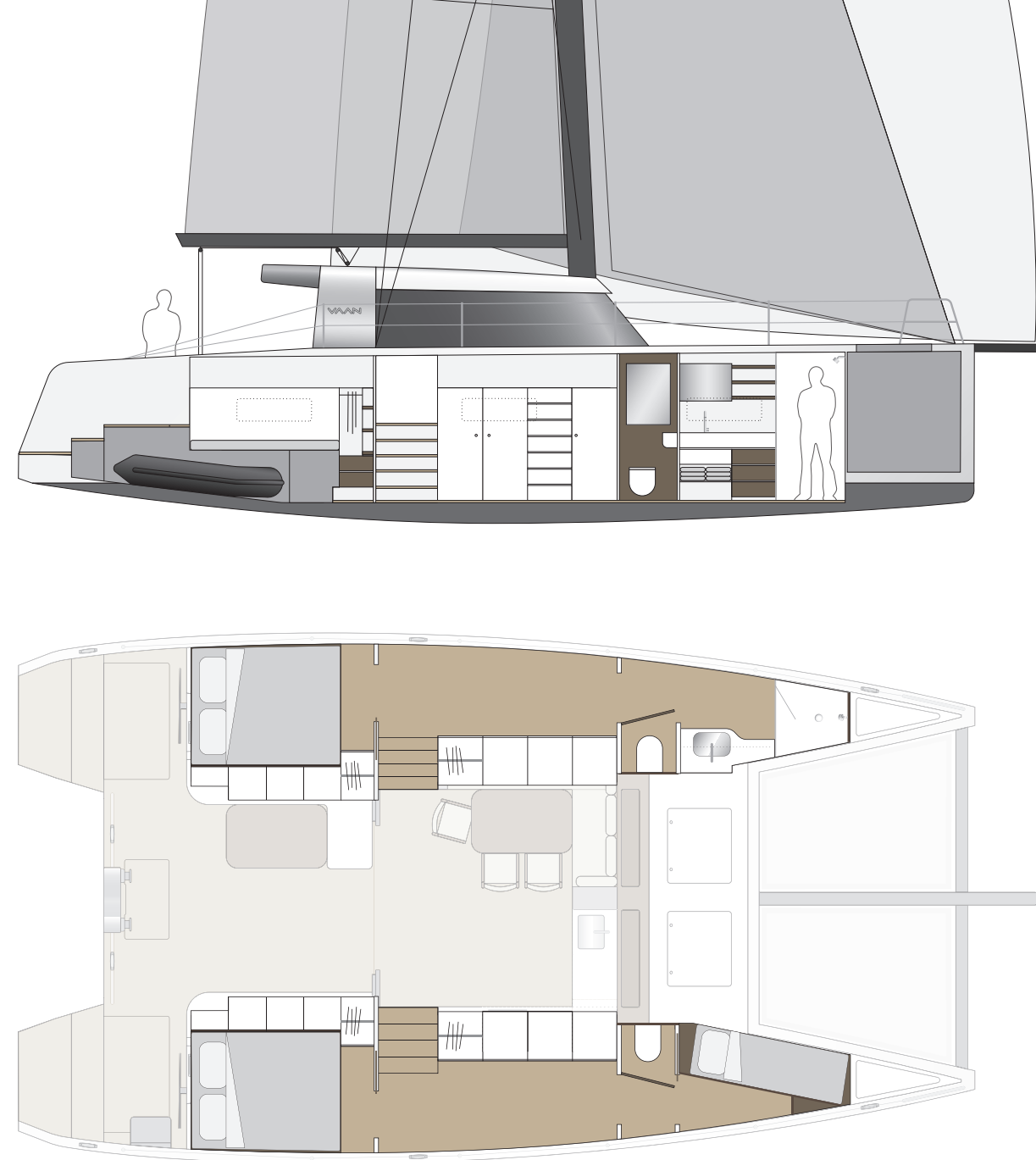



# LAY-OUTS

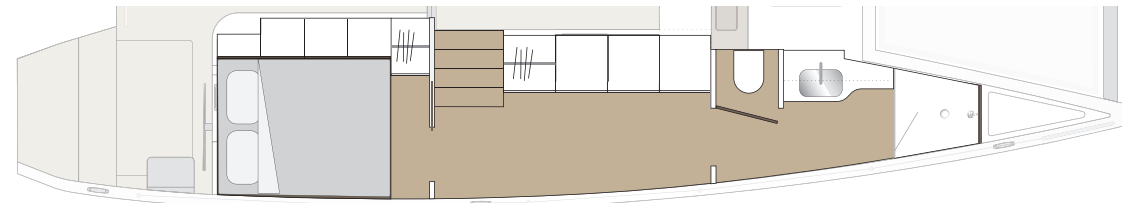

*Extra Master Bed*

*Second Large Bathroom*

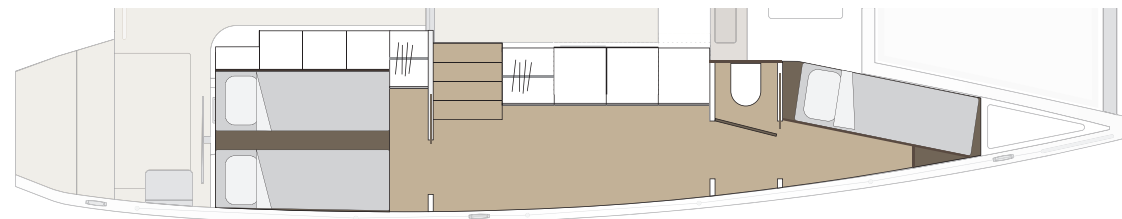

*Sliding Double Bed*

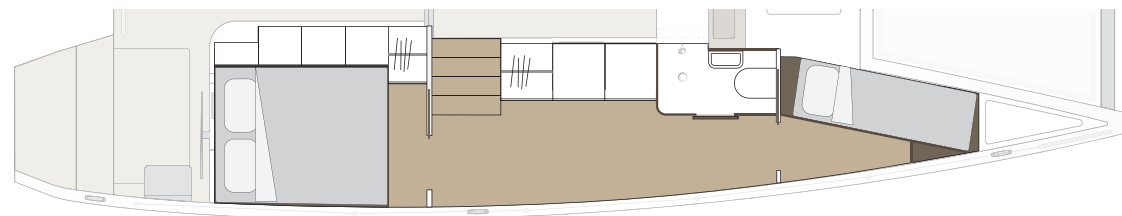

*Mid Bathroom*

# OPTIONS

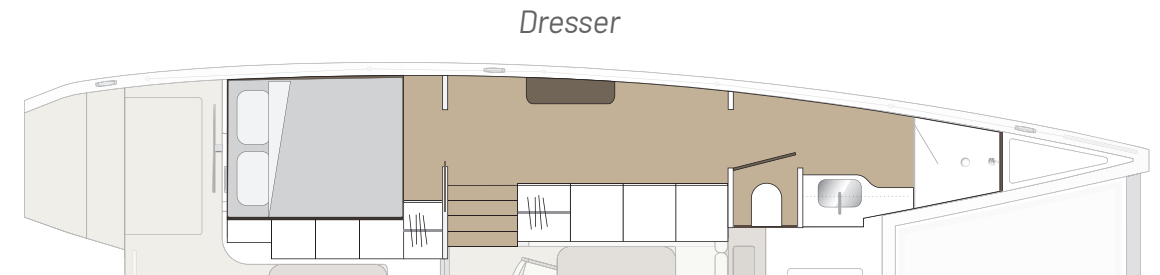

The guest hull offers subtle different options. It features a twin bed that can easily be moved together to form a double bed. It has its own separate toilet and several options for the front cabin: bunk-beds, or a full-sized second bathroom.



## TORQUEEDO

- 2x FP12 saildrive
- Power: 2x 12kW  
(similar to 2x 25Hp combustion)
- Hydro Generation: no
- Power 48-5000 batteries  
20 or 40 kWh
- Optional generator: 10kW



## OCEANVOLT

- 2x SD15 saildrive
- Power: 2x 15kW  
(similar to 2x 30Hp combustion)
- Hydro Generation:  
up to 2x 1kW (standard)  
up to 2x 2.5kW (servo-prop)
- MG LFP batteries  
21 or 42 kWh
- Optional generator: 15kW





# SPECIFICATIONS



- Main : 55 m<sup>2</sup>
- Jib (ST) : 30 m<sup>2</sup>
- Gennaker : 135 m<sup>2</sup>
- Code-0 : 85 m<sup>2</sup>

12.80m / 42ft  
Displacement: 10,9T

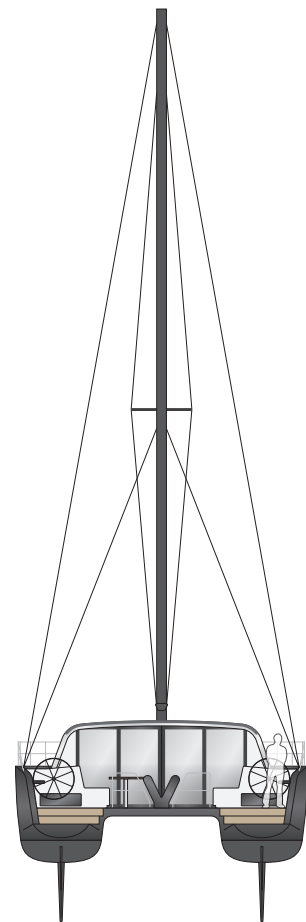

7.06m

19.80m

# POLAR DIAGRAM

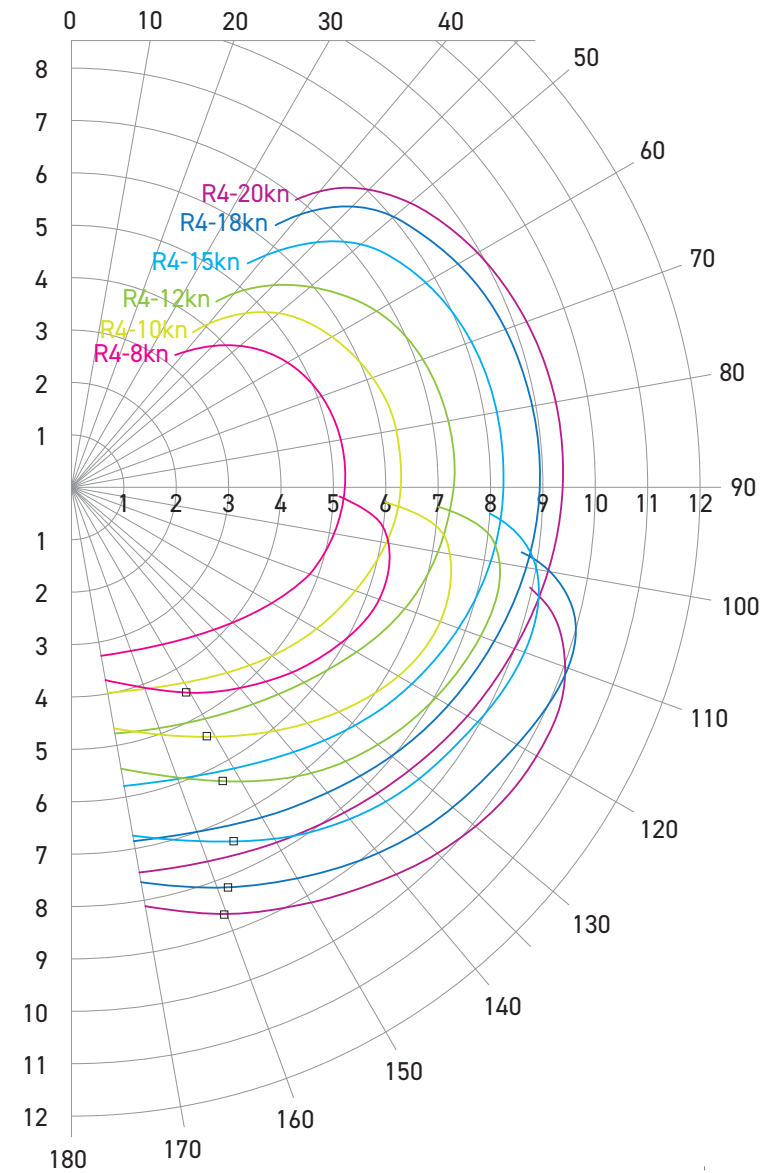

**VAAN R4**  
• Loa: 12.80m (42ft)  
• Beam: 7.05m  
• Sail area upwind: 85m<sup>2</sup>  
• Sail Area Downwind: 190m<sup>2</sup>

**VPP CALCULATION**  
• By Dykstra Naval Architects  
• Max RM 100kNm

**AERO**  
• Coefficients from Windesign  
• No reefs  
• Flat internal method  
• Windspeed at masthead  
• Windangle relative to tack

**HYDRO**  
• CFD calculation  
• Calculation run for flat water







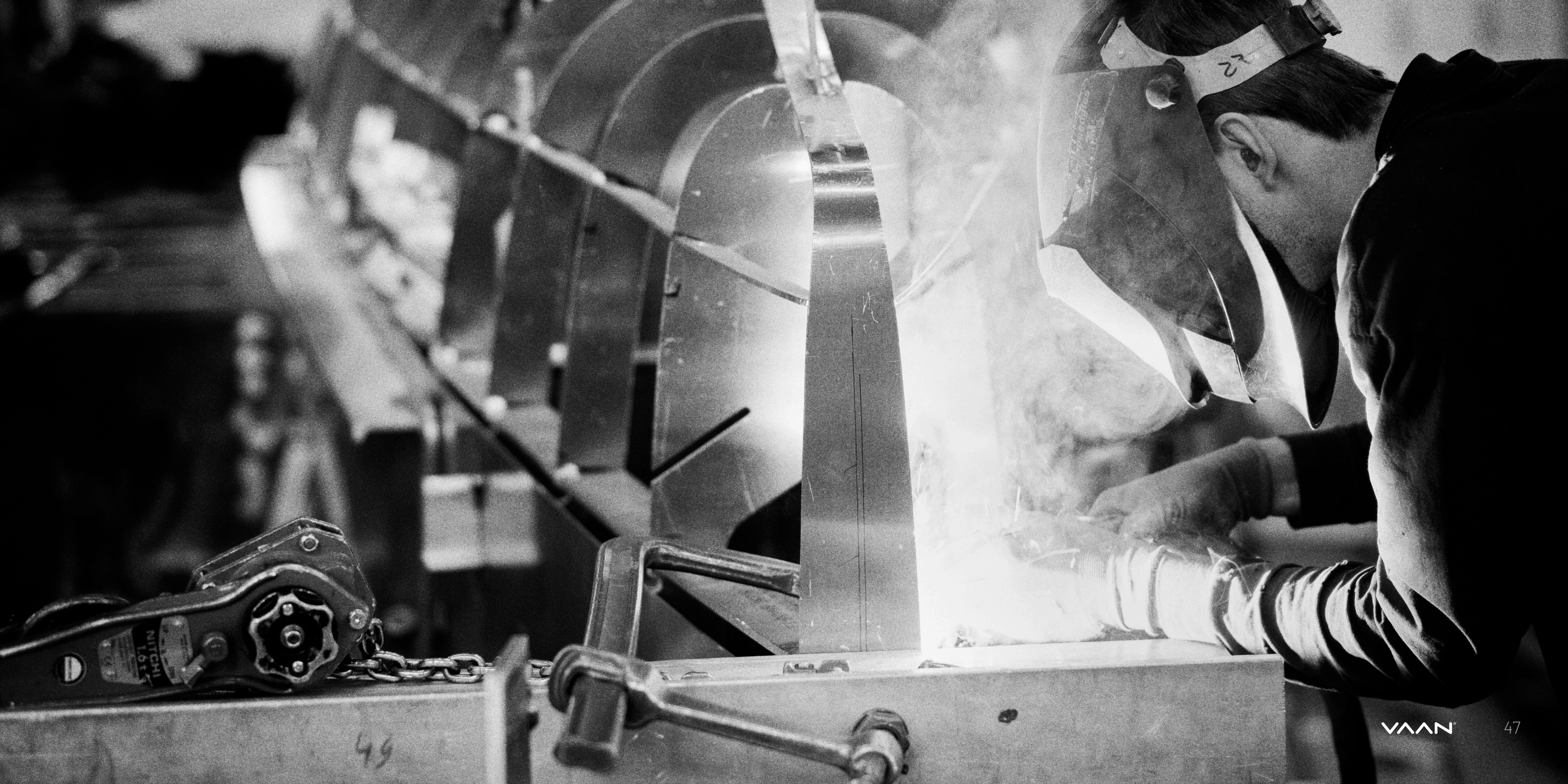





GO THE DISTANCE

At 49ft the Vaan R5 really goes the distance. A luxury platform to explore the most distant places and faraway islands. A spacious sailing machine for couples to

large families. And like every Vaan it is made of circular materials and almost entirely recyclable. A true testament to the Vaan mission: Sail the Planet.

R5



The image shows the interior of a modern sailing catamaran. On the left, there is a light-colored wooden dining table with a white tablecloth, supported by metal legs, and a matching wooden bench with white cushions. To the right is a kitchen area with white cabinetry, a white countertop, a black sink, and a black oven. A large, dark, cylindrical pillar stands in the center. The floor is a light brown carpet. Large windows on the left and right sides offer a view of a blue body of water and a green, hilly shoreline under a blue sky with white clouds. The ceiling is white with recessed lighting and two rectangular skylights.

## LIVE ANYWHERE

The open spaciousness of the R5 transforms this sailing cat into your penthouse on the water. Even with a family of six you can spend a year exploring the planet. And with the Live-Aboard version, indoor comfort is even more grand.







# EXTERIOR

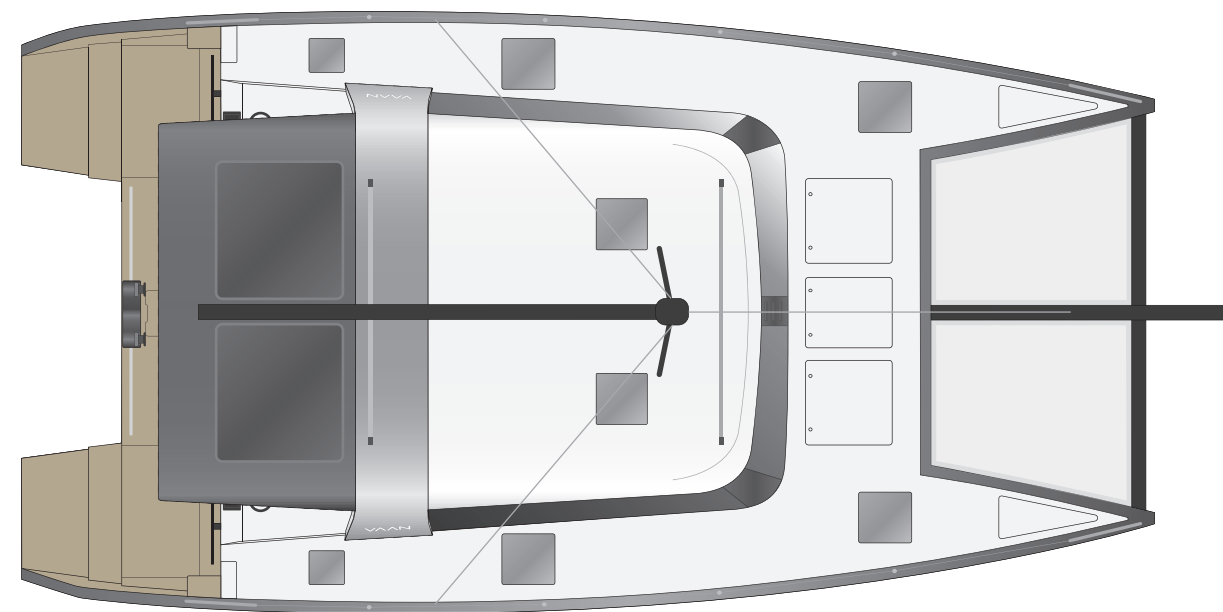



# COCKPIT & SALOON

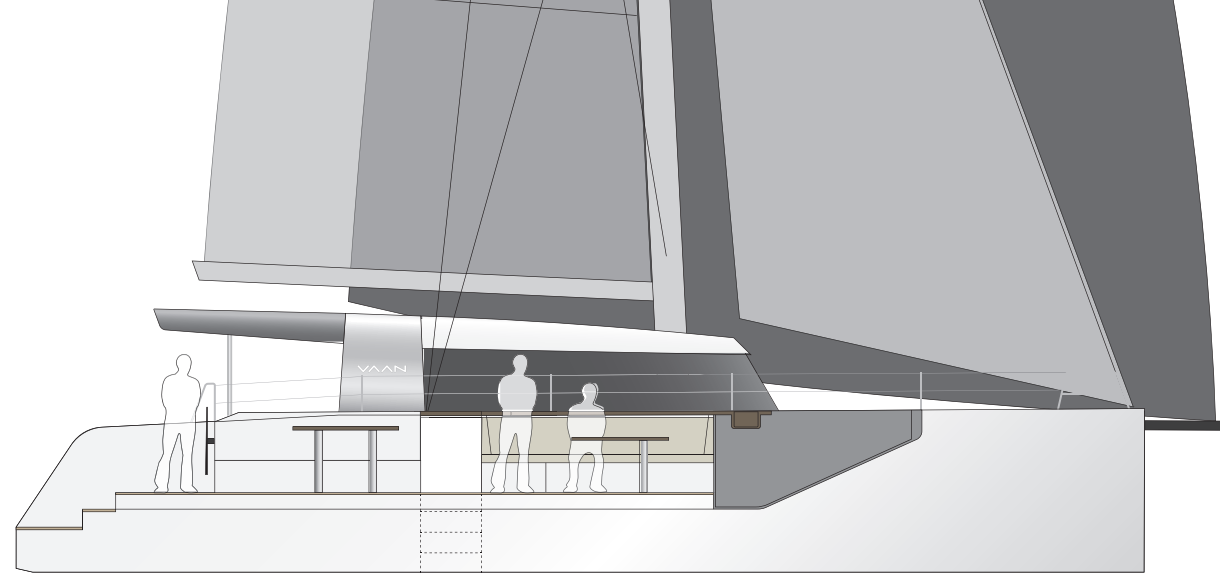
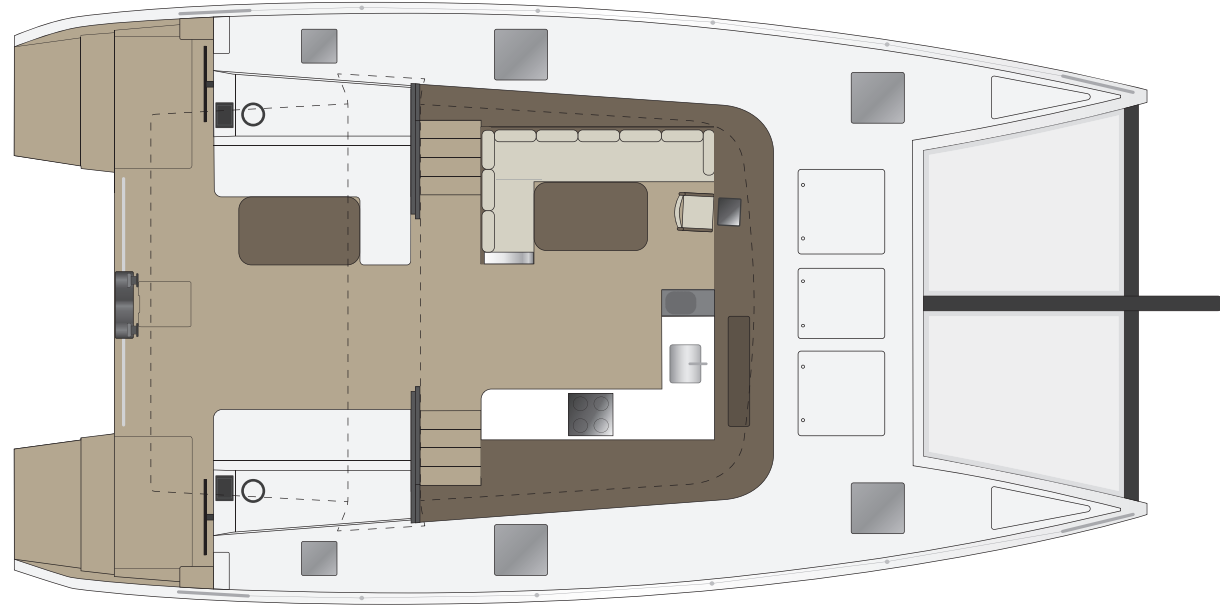

# THE OWNERS SUITE

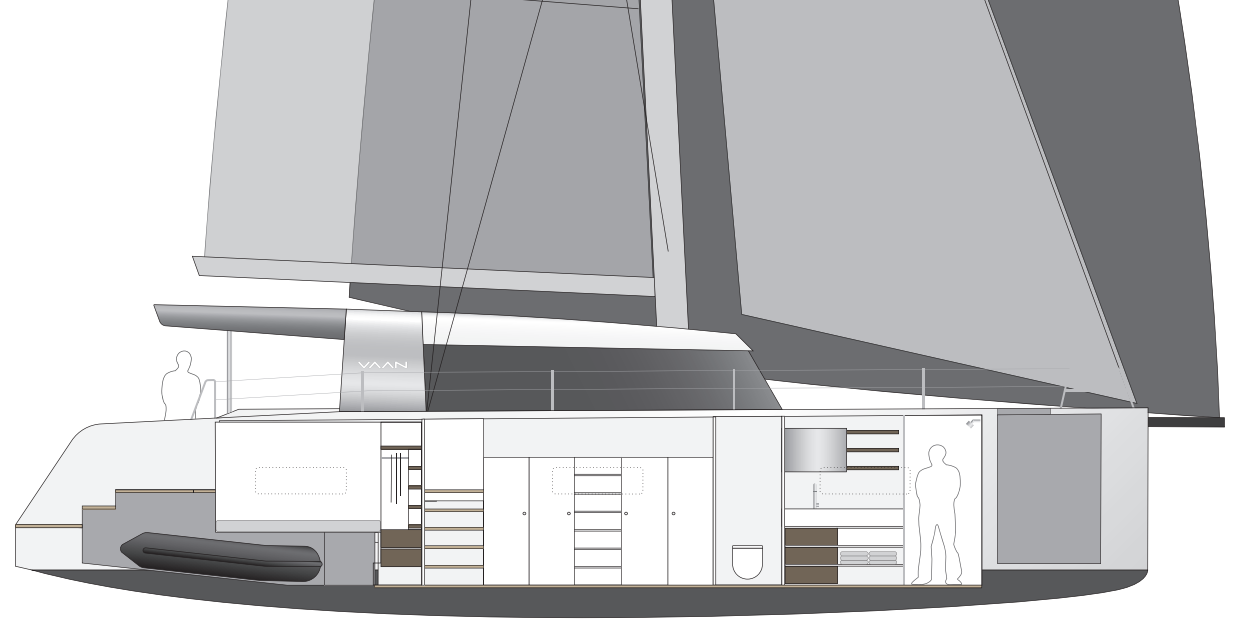
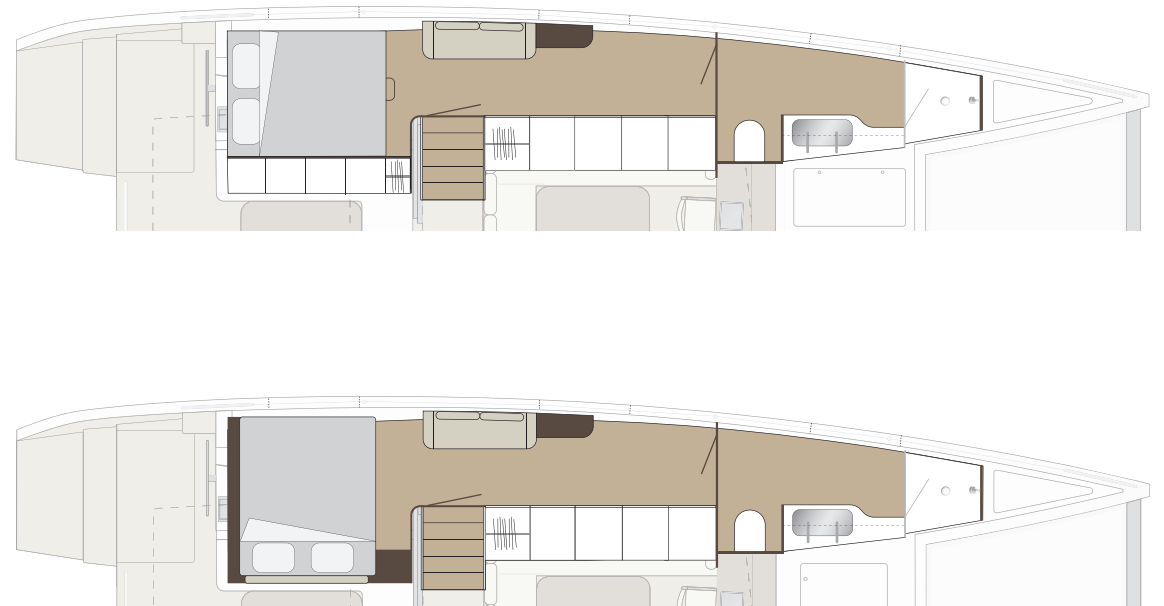





## MOVING FORWARD

The optional forward seating area offers a nice cooling breeze while at anchor. Or a beautiful sunrise view while you're having your first cup of coffee.

The table can be raised to provide seating for 3-4 people, or lowered to offer a large lounge bed. And why not fill the bottom section with some ocean water for the kids to play in or for you to cool off in? Hello jacuzzi:)



# LAY-OUTS

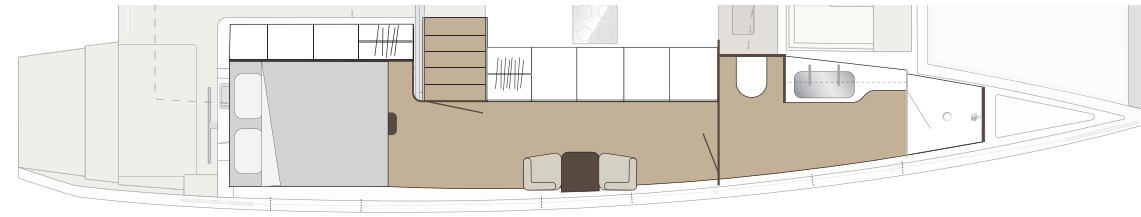

*Second master suite with walk-in closet and full bathroom*

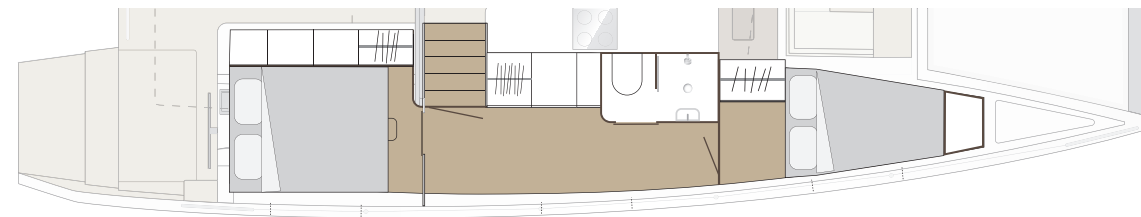

*Aft bedroom*

*Mid Bathroom*

*Tripezium Bed*

# OPTIONS

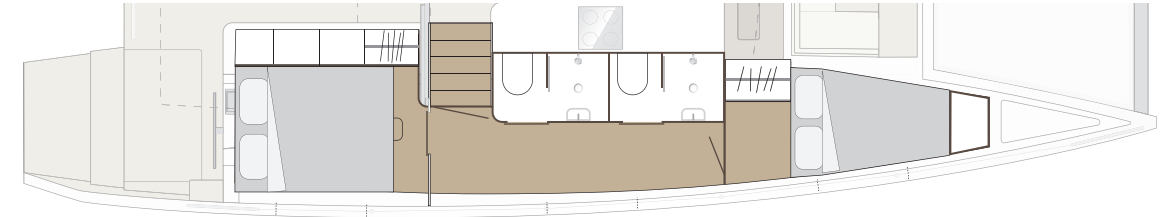

*Double Mid Bathroom*

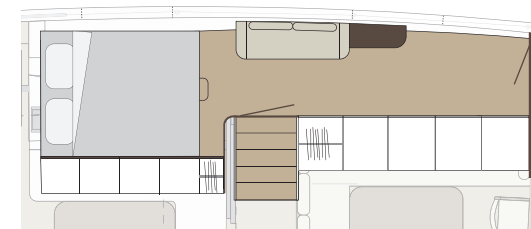

*Sofa + Dresser*

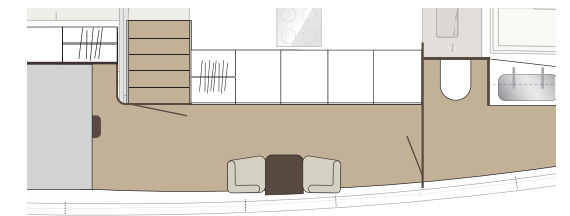

*Table with Seats*



# THE LIVE-ABOARD

With the sliding glass door moved further aft, part of the cockpit becomes part of the interior space creating a saloon area of 30m<sup>2</sup>.

No flapping tents, zippers and view distorting plastic but crystal clear floor-to-ceiling glass all the way around. For different parts of the world or sudden weather changes, the R5 LA offers the best of all worlds.





# LIVE-ABOARD VERSION



- Sliding doors moved aft
- 30m<sup>2</sup> saloon space
- Side windows slide open

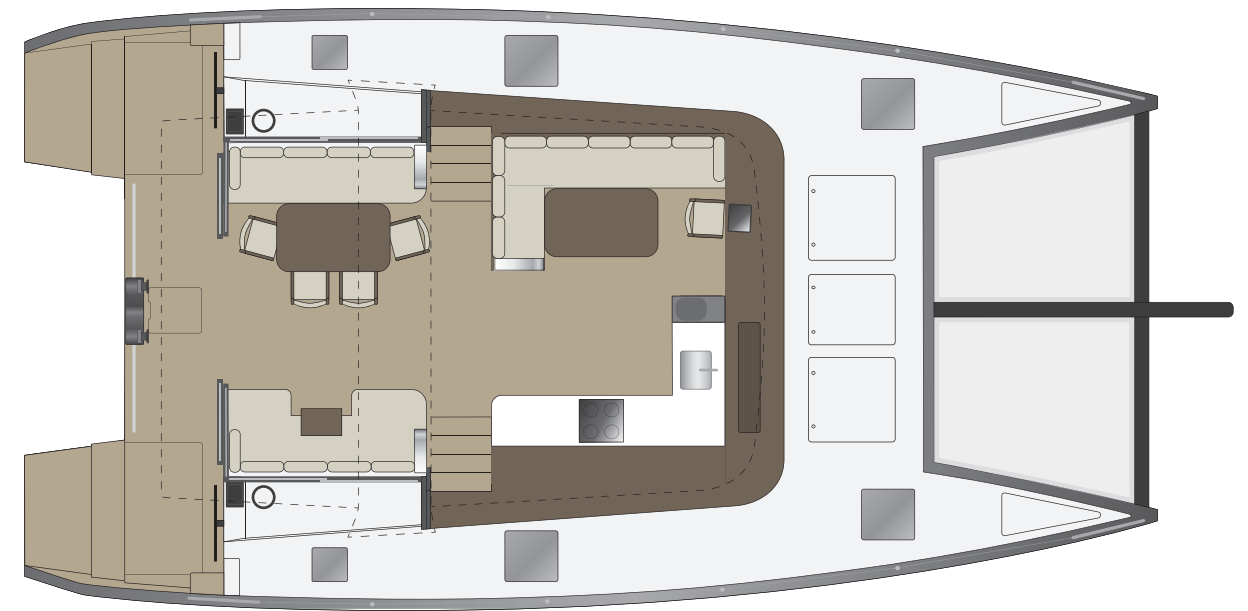





## MOVED BY NATURE

All that space, all that comfort, is matched by the R5's sailing qualities. This is a true sailing yacht that is ready to go anywhere, both in light winds and strong ones. The wind in your face, a little splash of water, the sails feeling forceful. Sailing at its best.



## TORQUEEDO

- 2x Deep Blue saildrive
- Power: 2x 25kW  
(similar to 2x 40Hp combustion)
- Hydro Generation: no
- 40-80 kWh batteries
- Optional generator: 15kW



## OCEANVOLT

- 2x SD15 saildrive
- Servoprop option
- Power: 2x 15kW  
(similar to 2x 30Hp combustion)
- Hydro Generation:  
up to 2x 1kW (standard)  
up to 2x 2.5kW (servo-prop)
- Valence LiFePO4 batteries  
20 or 40 kWh
- Optional generator: 15kW





# SPECIFICATIONS

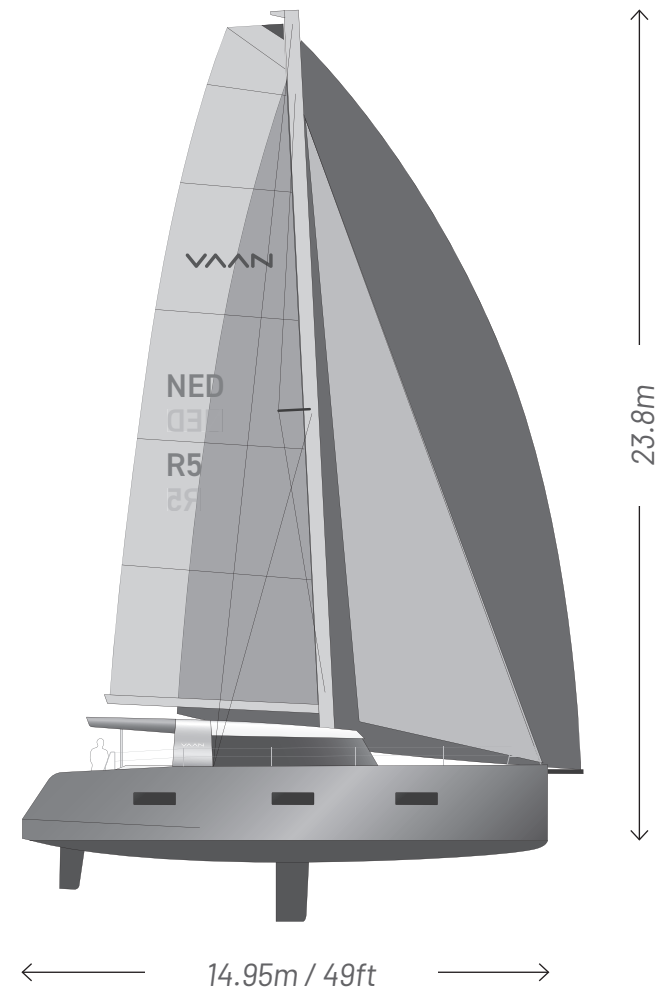

## SAIL AREAS

- Main : 80 m<sup>2</sup>
- Jib (ST) : 45 m<sup>2</sup>
- Gennaker : 170 m<sup>2</sup>
- Code-0 : 120 m<sup>2</sup>

# POLAR DIAGRAM

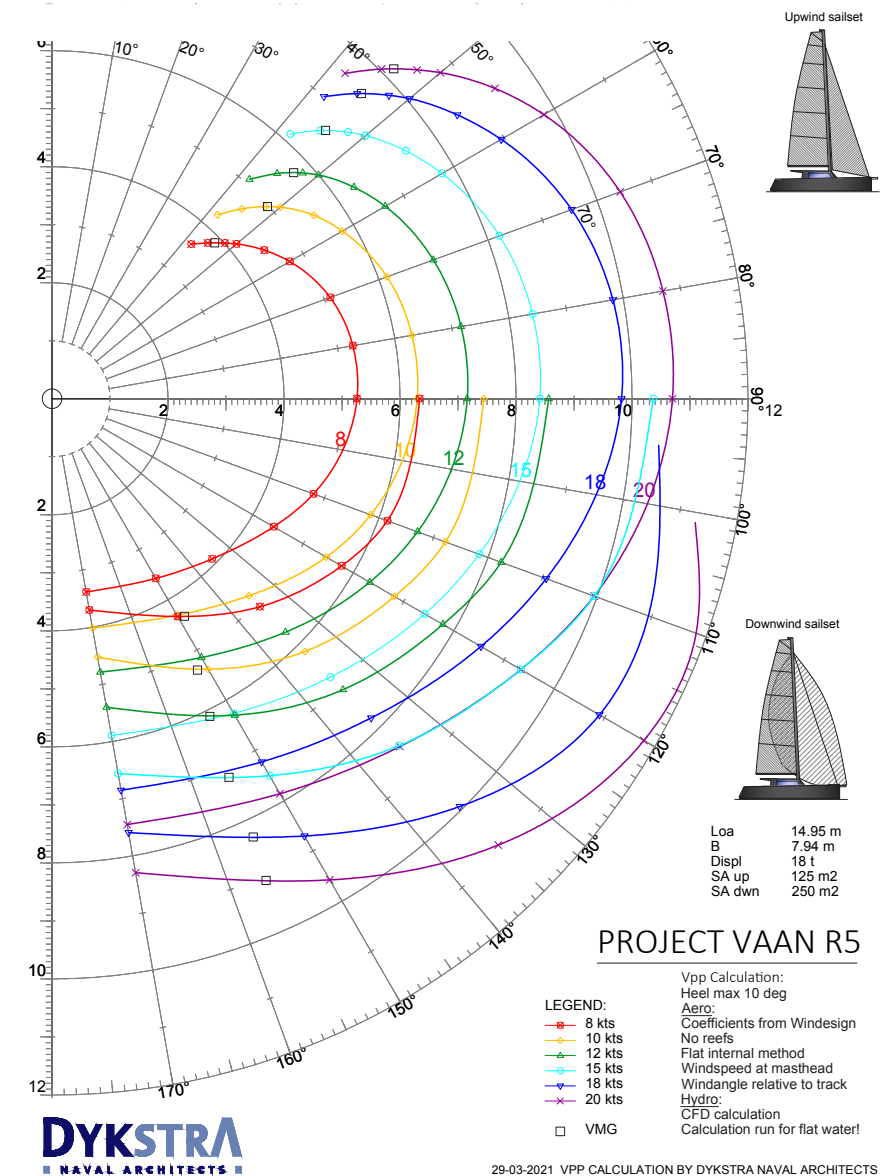



PAF20A-2

PAF20A-2

PAF20A-2

400PS-20A> 1.3  
-5-

PAF20A-3

PAF20A-3

PAF20A



# THE GRAND R6

At 58ft the Vaan R6 is a next step in sustainable luxury sailing. An owners yacht with incredible space, storage and stability. Made from our signature aluminium, with cork decking and electric propulsion the R6 too, is a truly sustainable sailing yacht.



# R6



YOUR ONLY FOOTPRINT WILL  
BE THE ONE ON THE BEACH









# TOGETHER AND CREWED

The R6 can easily be sailed by just two people. So you can experience ultimate privacy on your trips. The R6 also offers layouts for crewed voyages with 2 extra beds for the crew providing a maximum of 8+2 berths.





# UPPER DECK

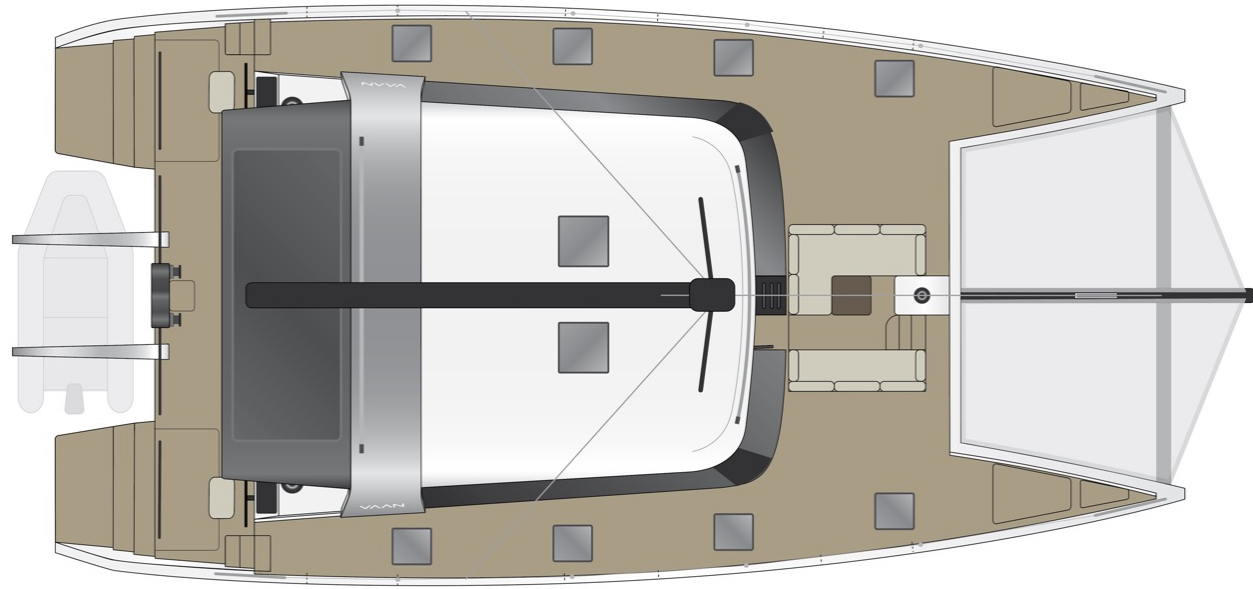

# SALOON

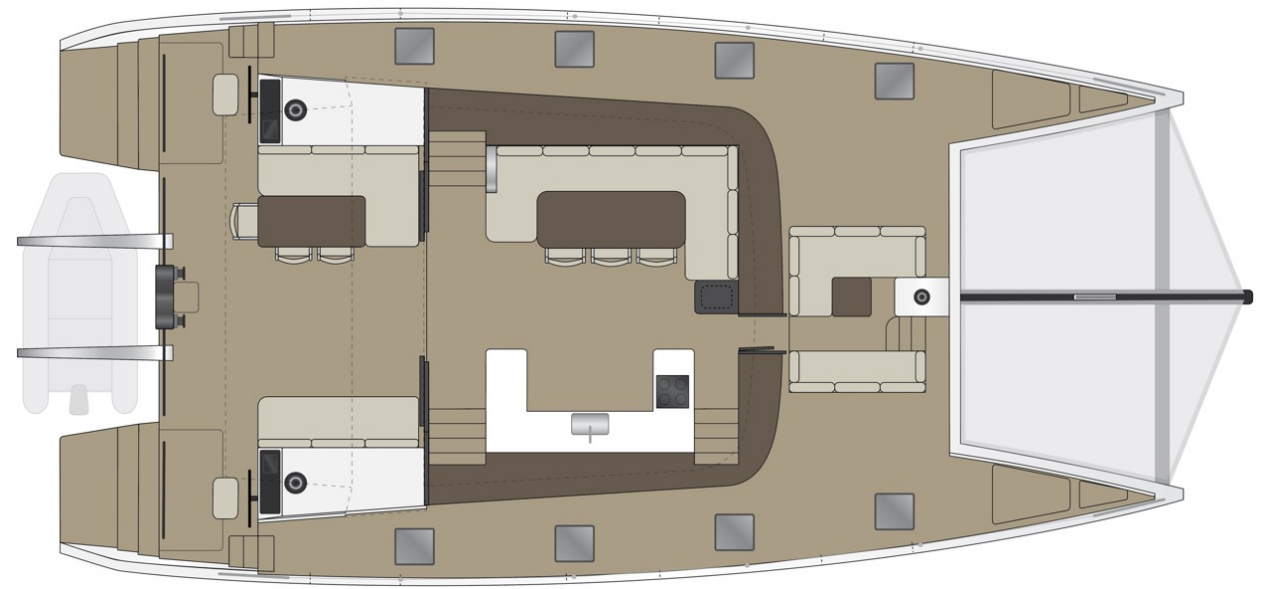



# KITCHEN XL

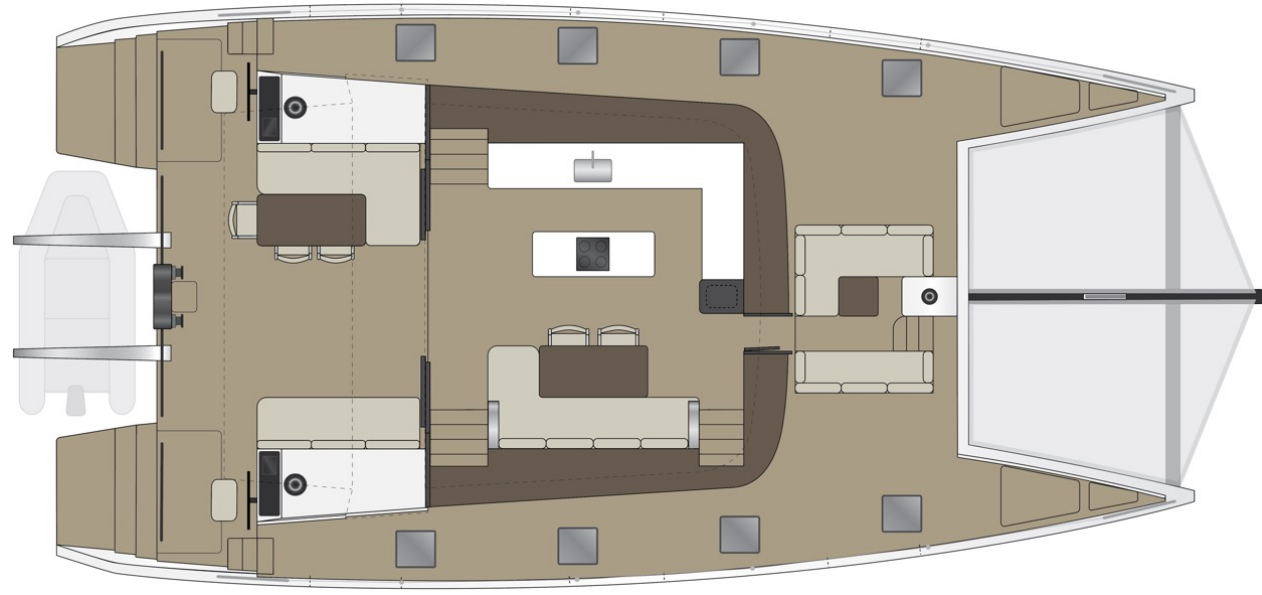

# EXTRA PS STAIRS

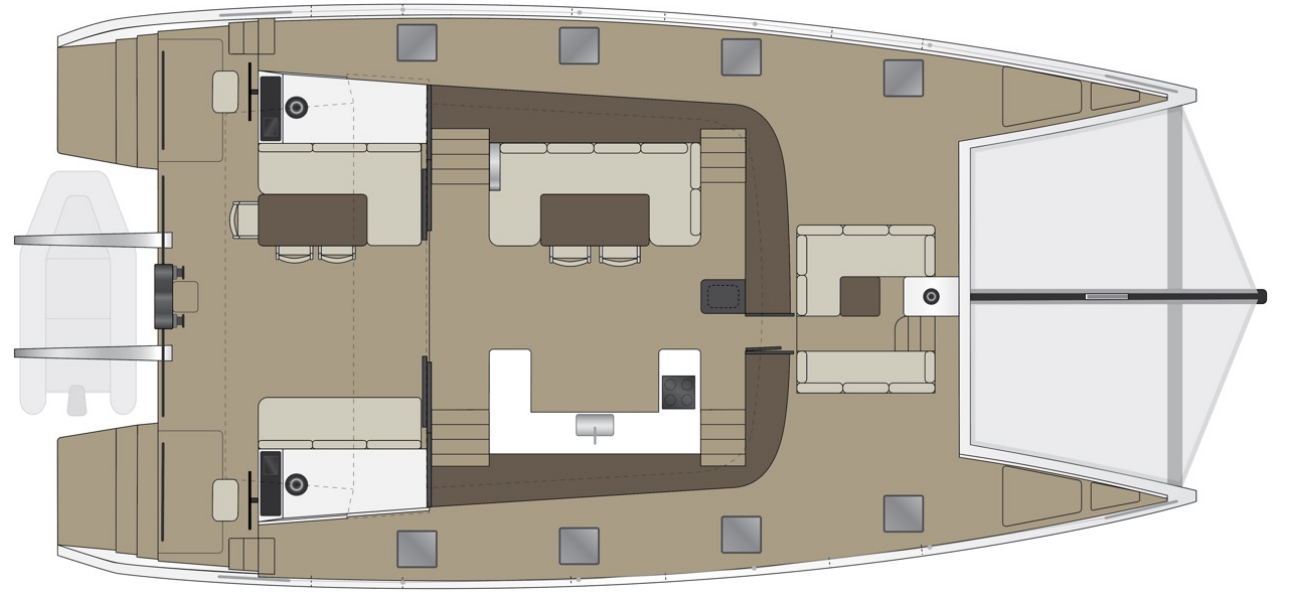



# HULL LAY-OUTS

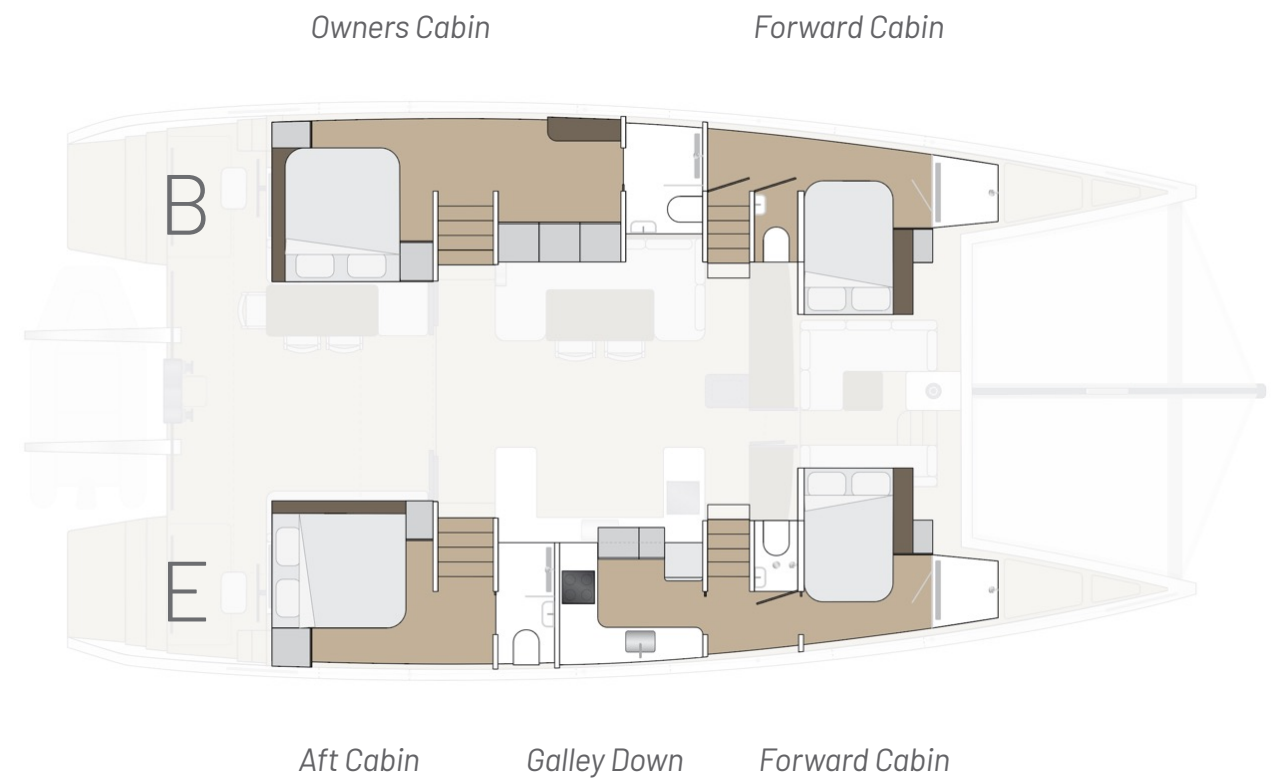
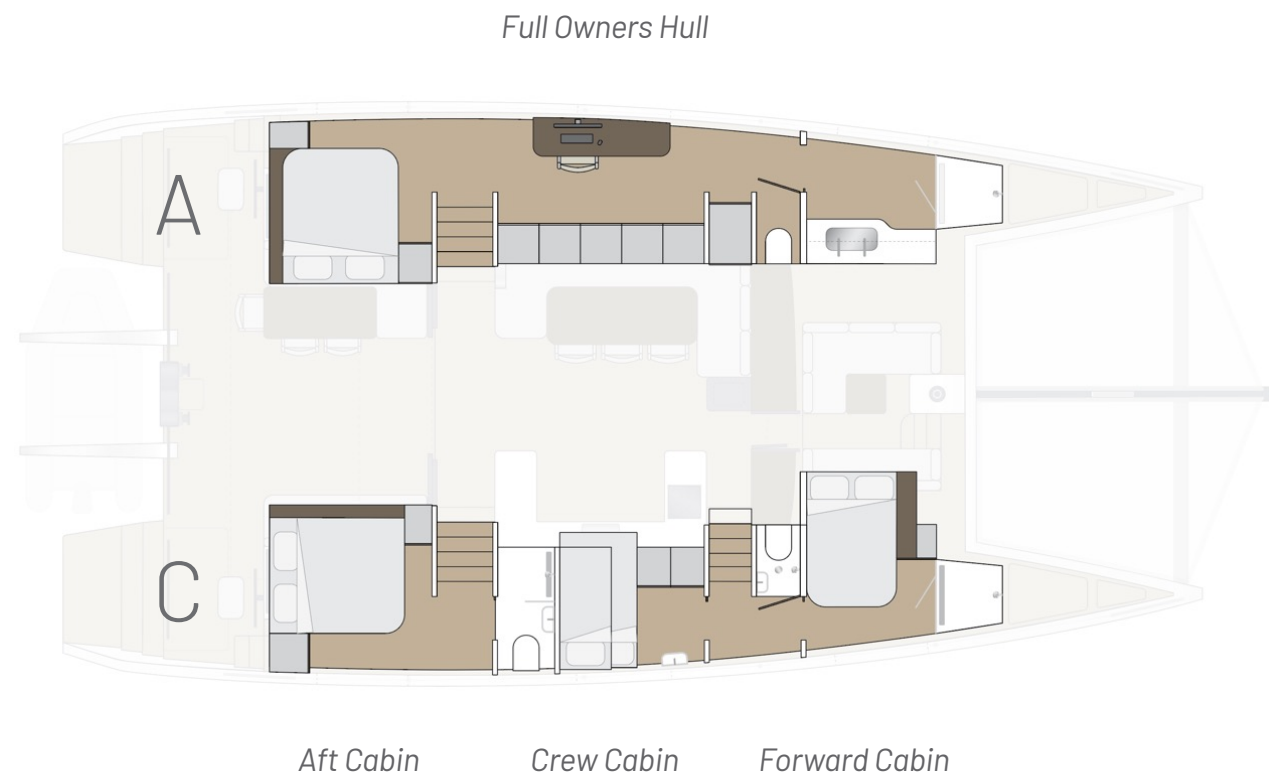



# DIMENSIONS

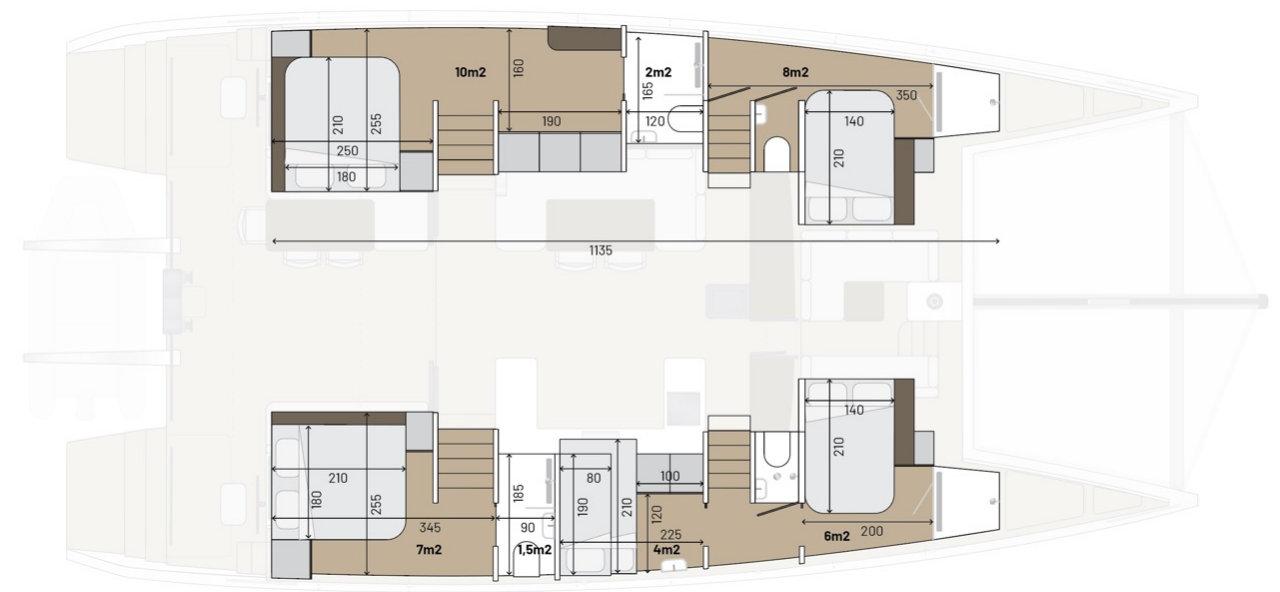
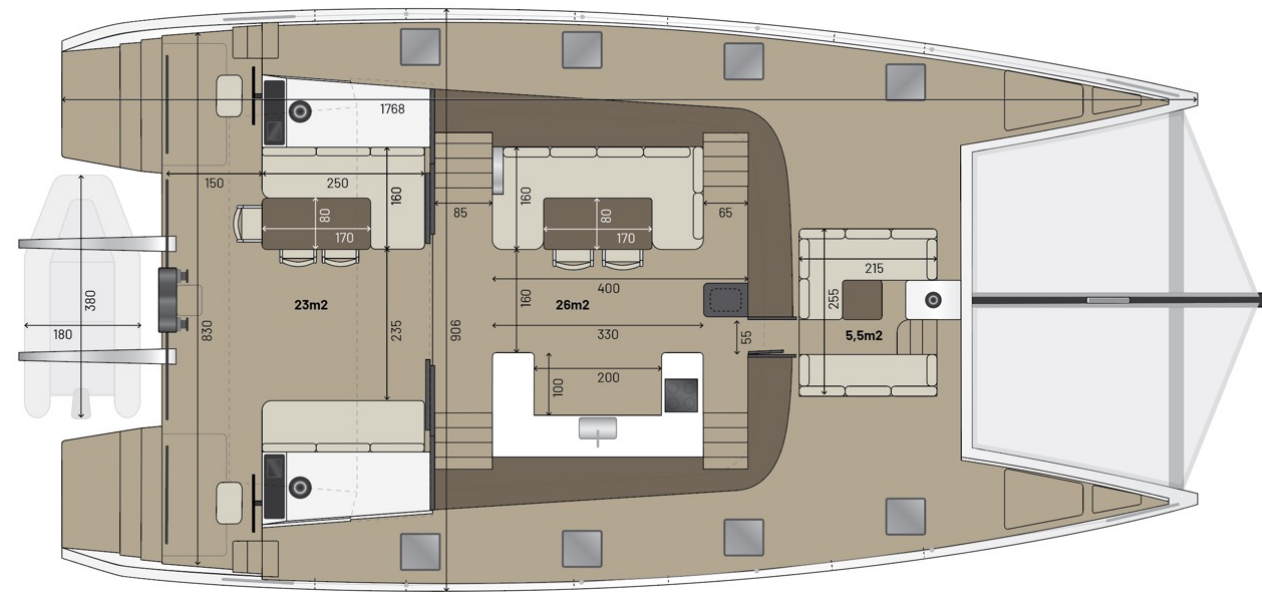

The plans, specifications, images and other details herein are only indicative and subject to change.



# SOLAR

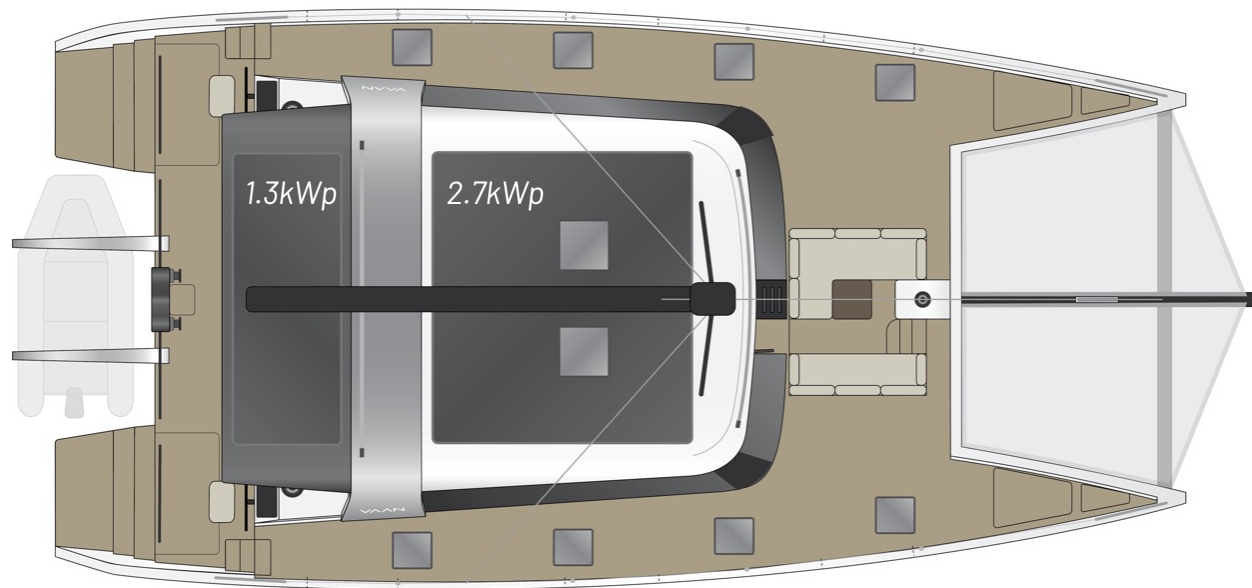

# SPECIFICATIONS

## MAIN DIMENSIONS

- LOA: 58ft / 17.68m
- BEAM: 9.08m
- MAST: 27.50m
- DISPLACEMENT: 22.5t
- BRIDGE DECK: 95cm

## SAIL AREAS

- Main: 110m<sup>2</sup>
- Jib: 65m<sup>2</sup>
- Code-0: 150m<sup>2</sup>
- Gennaker: 200m<sup>2</sup>

## PROPULSION

- 2x OCEAN VOLT HPSP25 saildrive
- Power: 2x 25kW
- Solar 1.3kWp to 4.0 kWp
- Opt. generator: 22kW or 2x11kW





# R8

CONCEPT

*The plans, specifications, images and other details herein are only indicative and subject to change.*







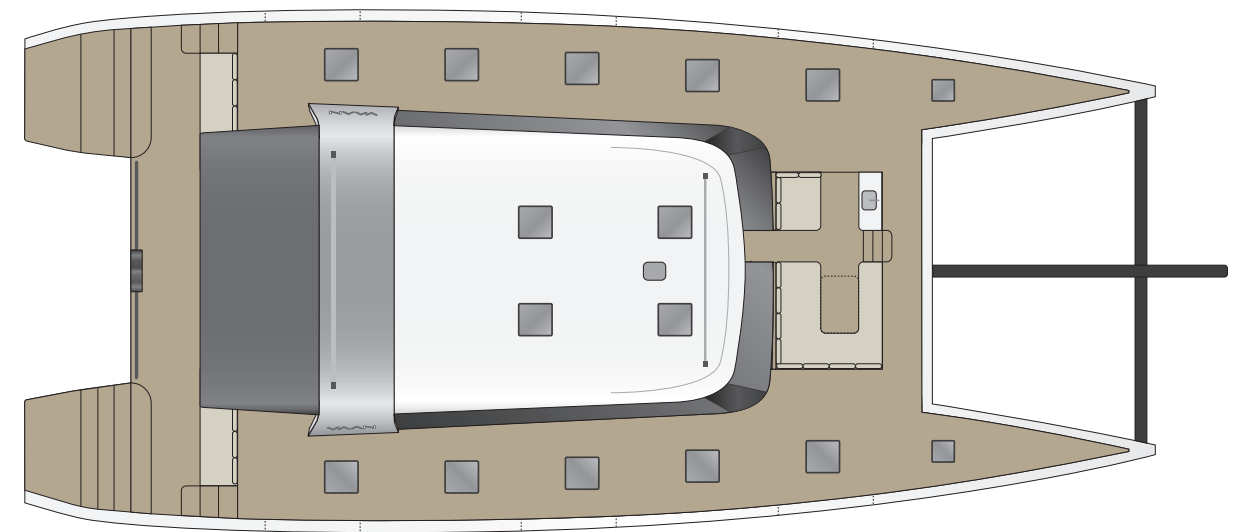
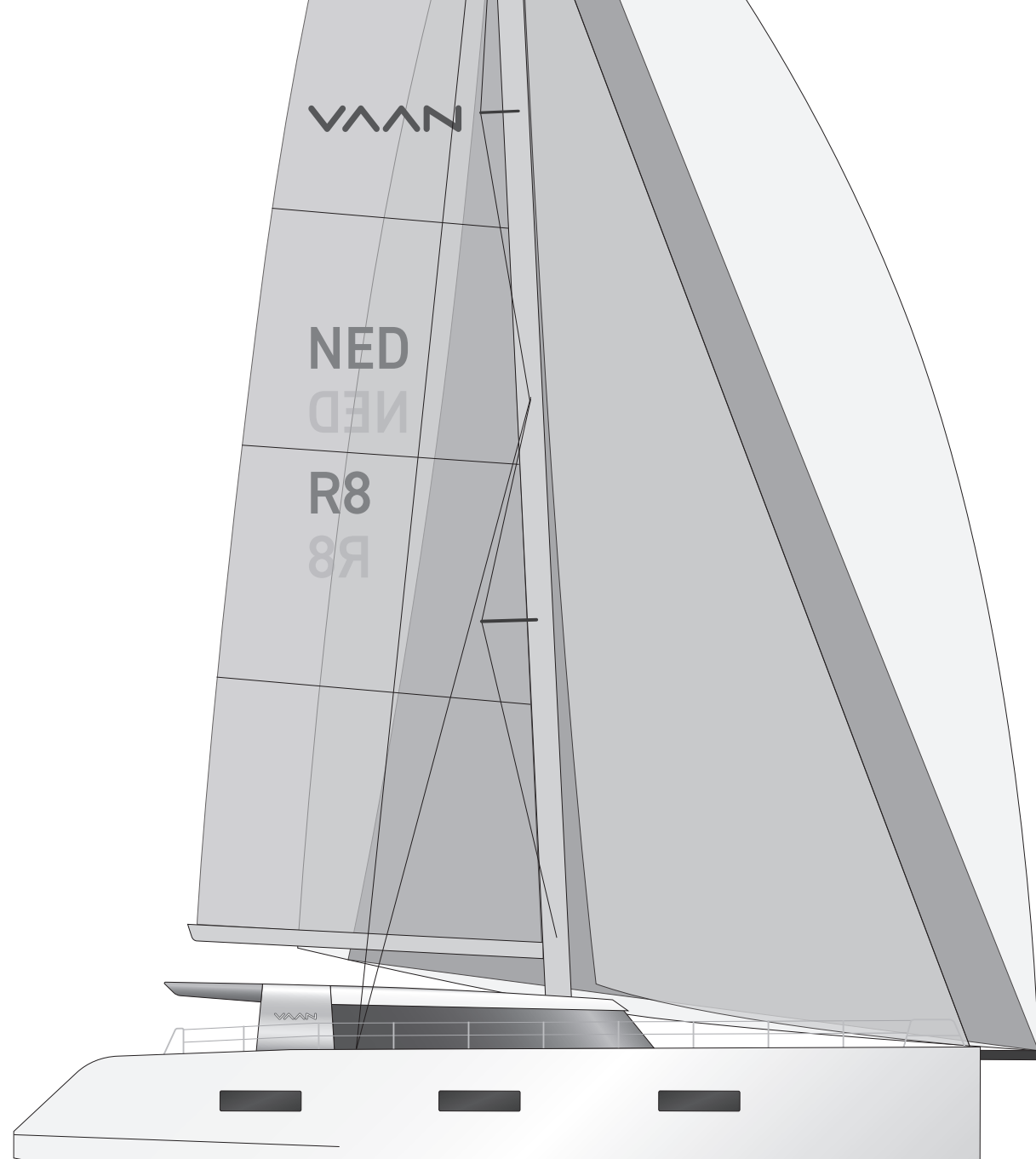

- Length: 78ft / 23.80m
- Beam: 11m



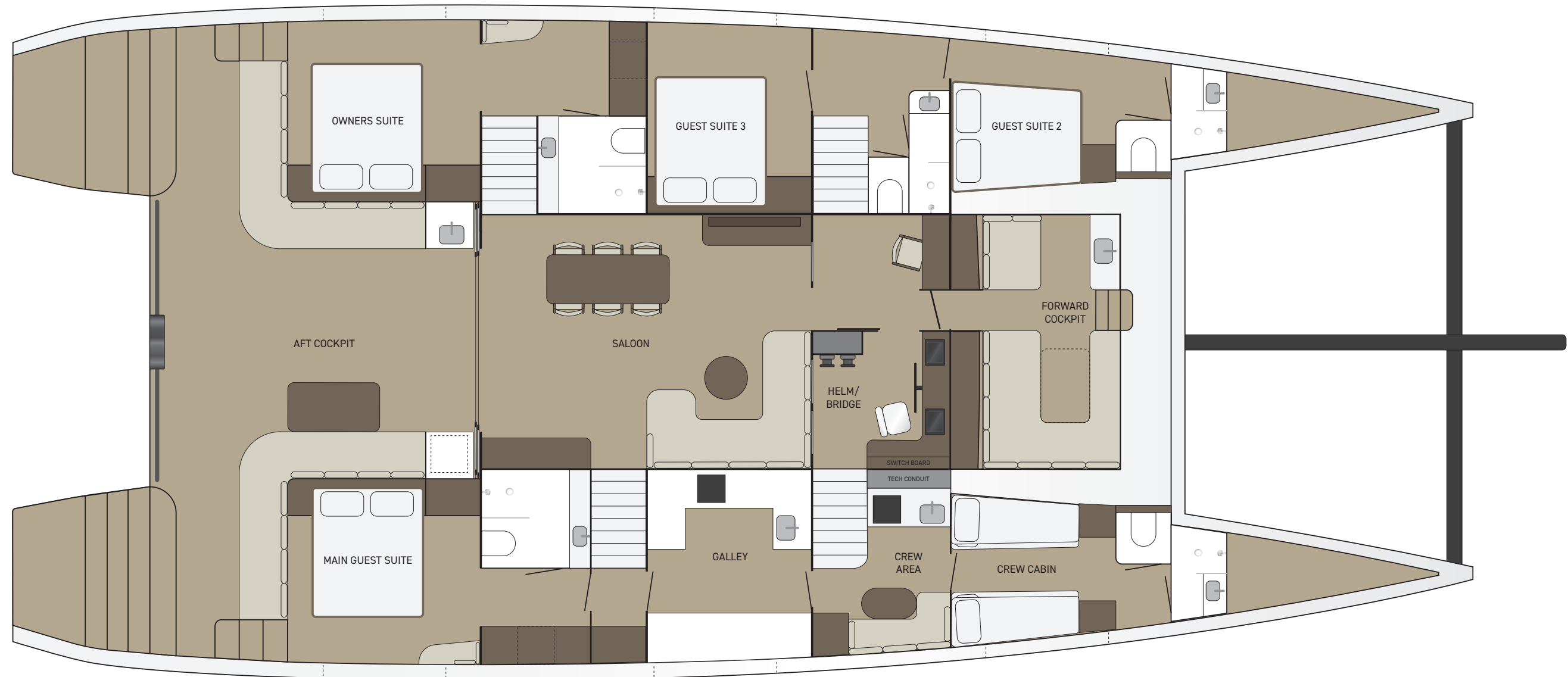









OPTIONS



# LOUNGE

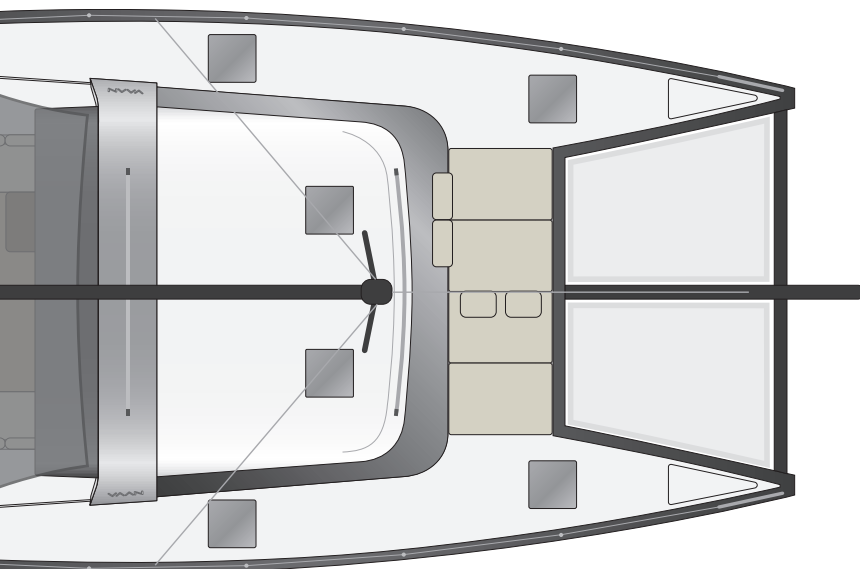
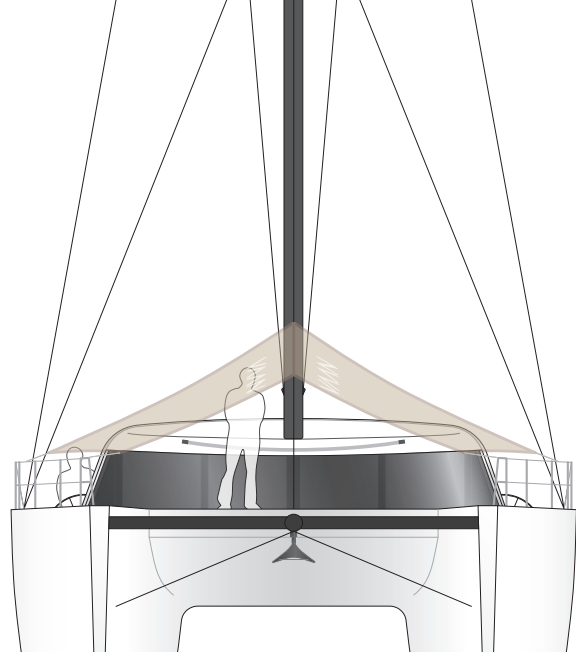

- Large lounge cushions
- (Partially) shaded when desired
- Installed in minutes
- Light-weight

# BIMINI

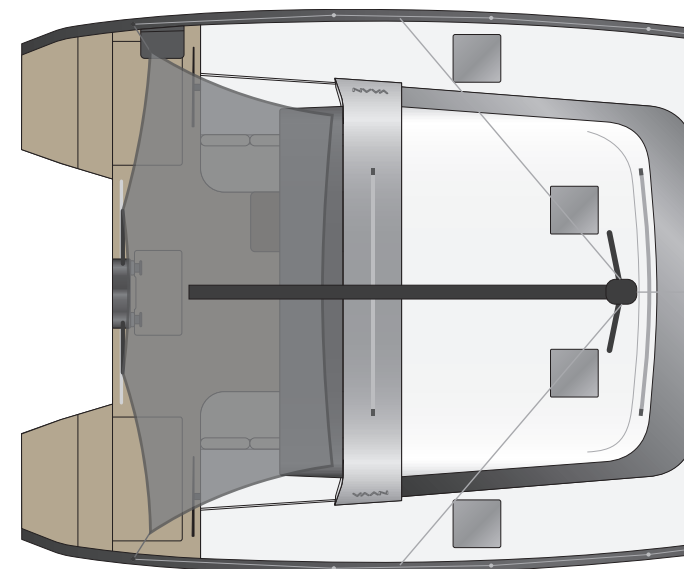
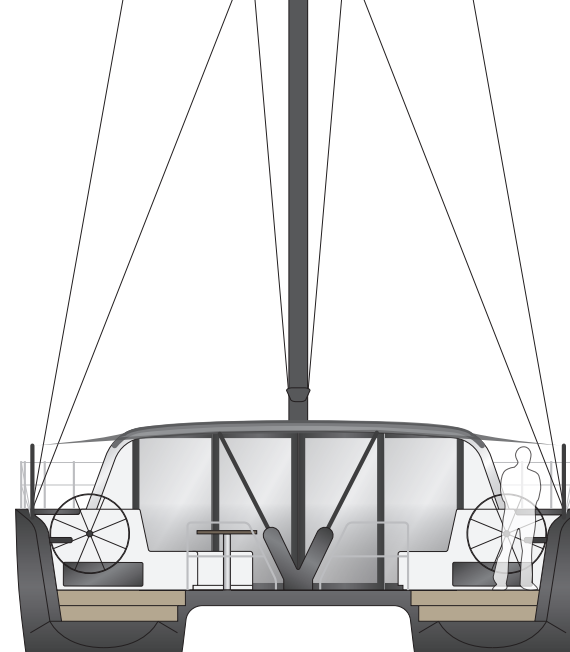

- Covers entire cockpit, including both helm positions
- Installed in minutes
- Light-weight



# EXTRA SOLAR

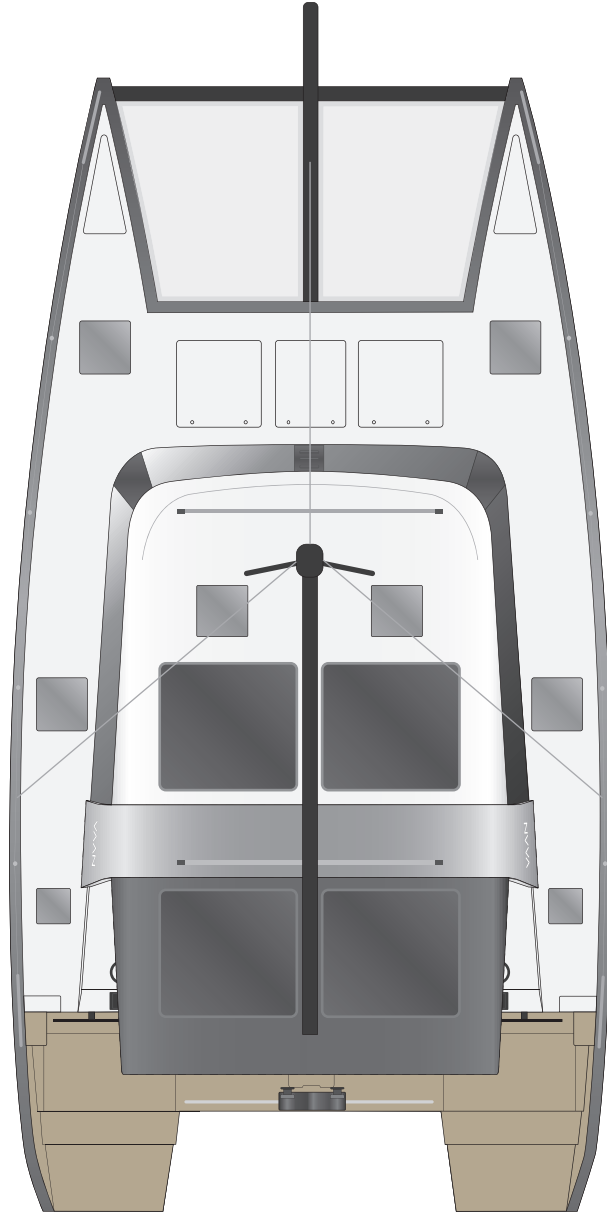

# SEATS & RAILINGS

- *Rear benches provide seats & storage*
- *Extra removable rigid railings behind helm positions*
- *(re)movable swivel chair(s) behind helm positions (R5, R6)*

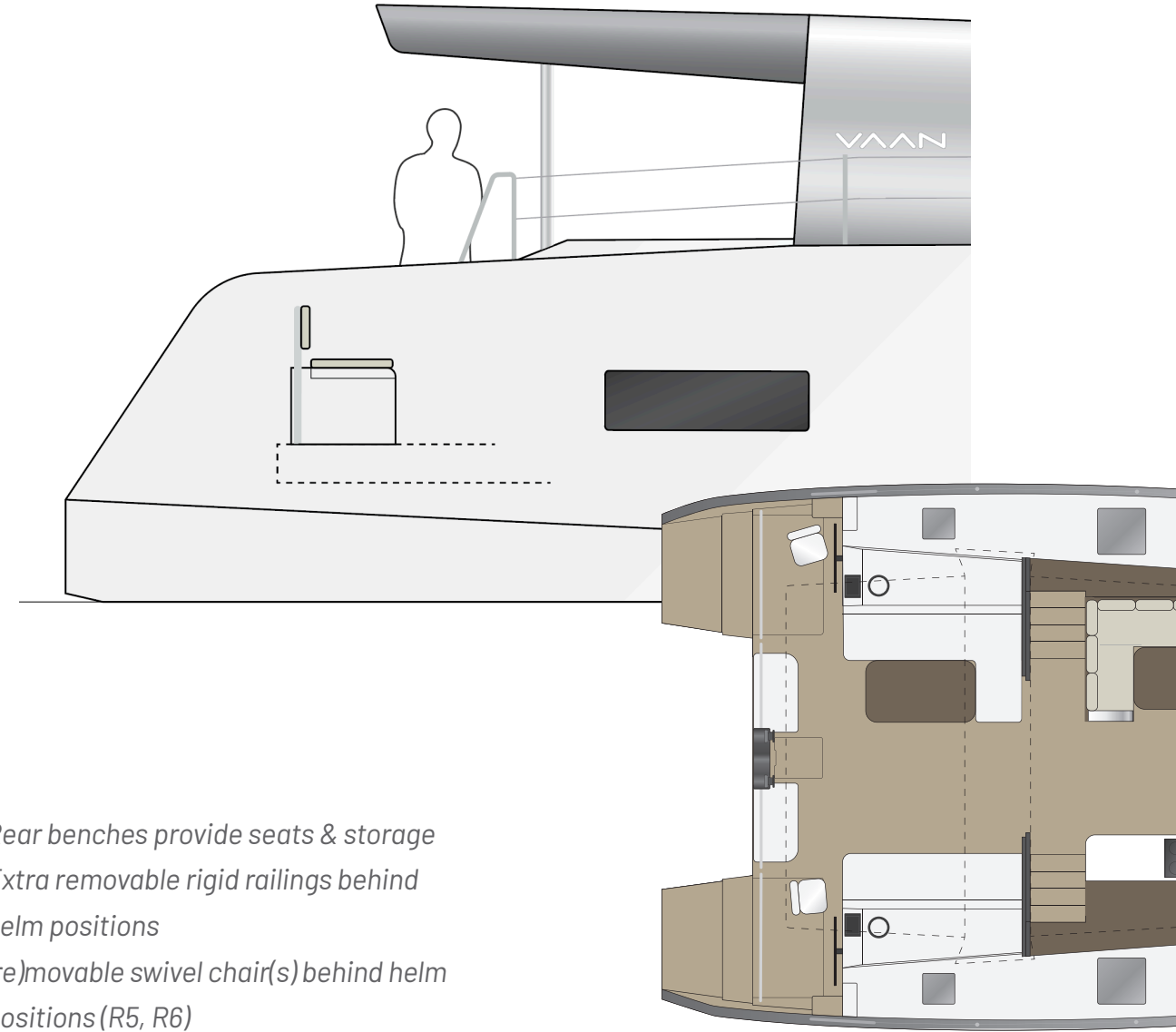



## FORWARD SEATING

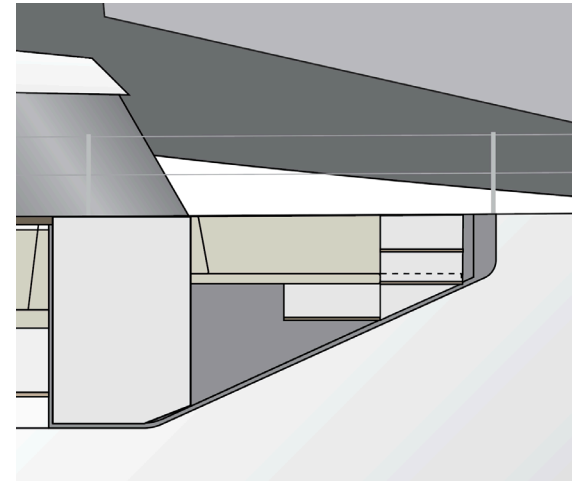
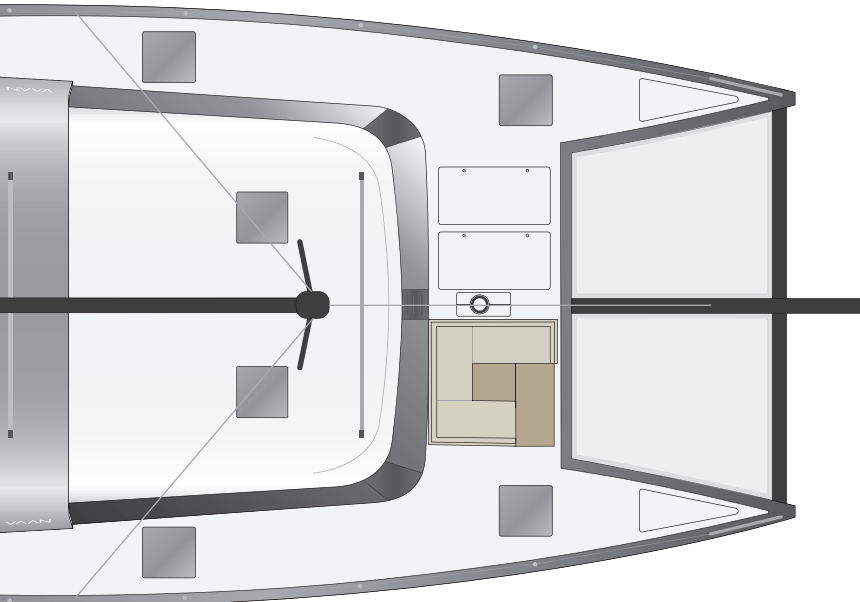

- R5 and up only
- Space for 4 sitting upright/dinner
- Table lowers for full lounge bed

The plans, specifications, images and other details herein are only indicative and subject to change.

## DAVITS

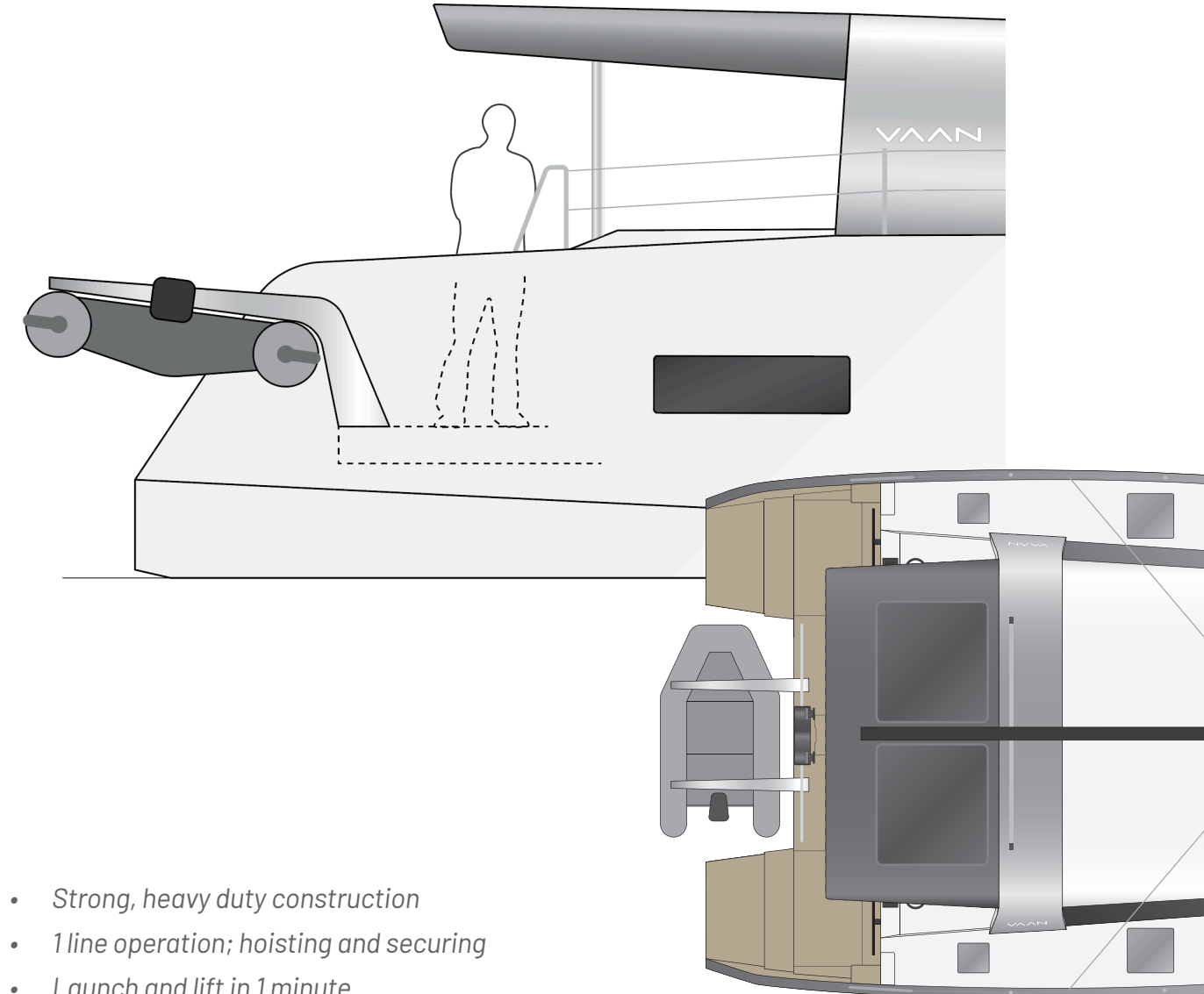

- Strong, heavy duty construction
- 1 line operation; hoisting and securing
- Launch and lift in 1 minute



## COCKPIT TENT

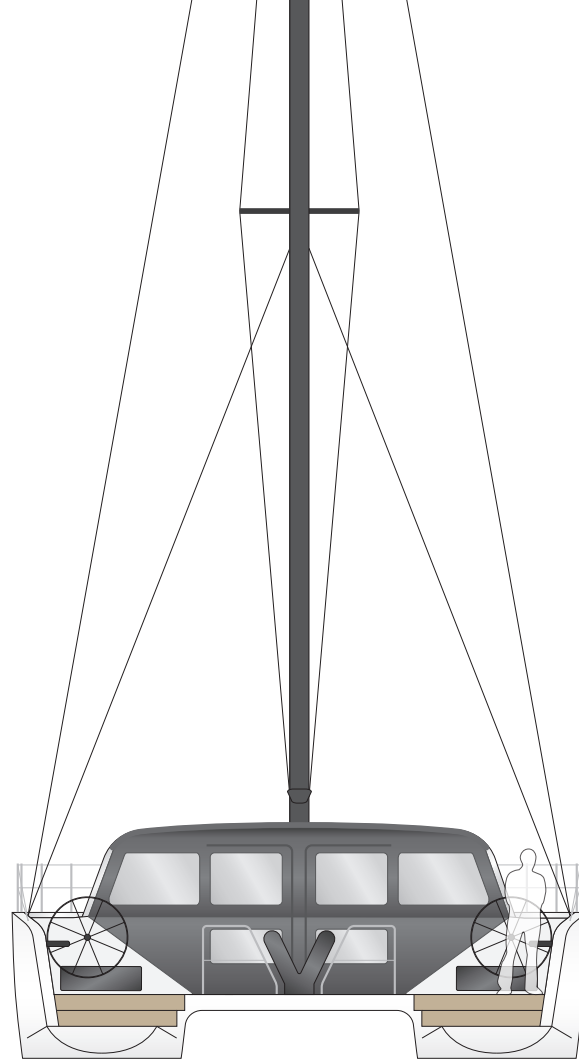

- Creates enclosed 'outdoor' area
- Continue sailing with tent installed
- Extends sailing season
- Installed in minutes

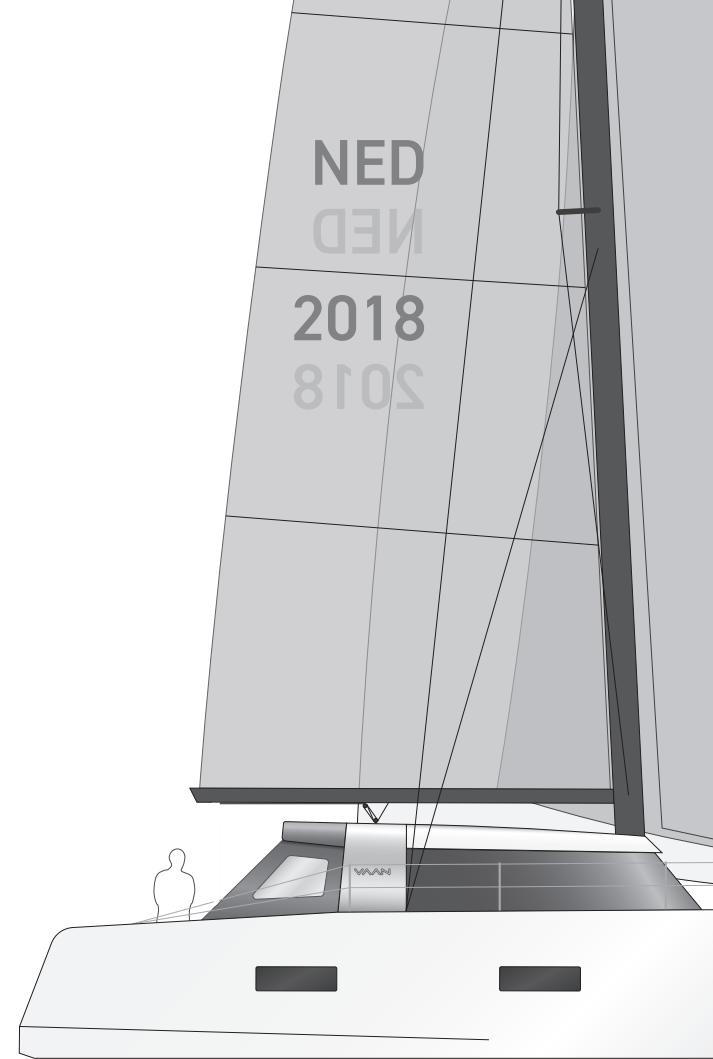

## HULL COLORS



BARE ALUMINIUM  
STANDARD



SNOW WHITE  
OPTION

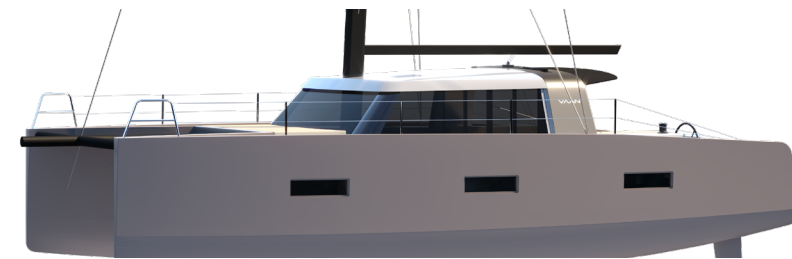

STONE GRAY  
OPTION

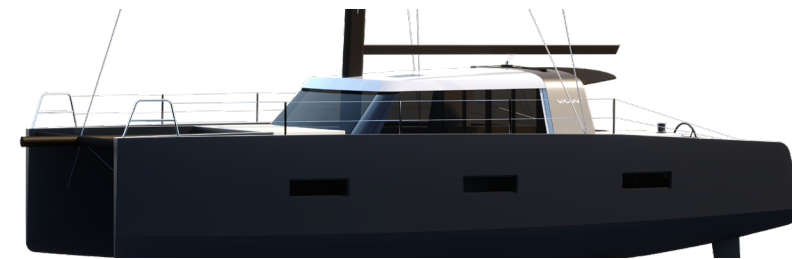

LAVA BLACK  
OPTION



*"There is something magical about sailing. Being moved by nature, propelled by the wind, you can go, wherever you want to go, naturally.*

*Sailing makes you humble. At the mercy of the sky and sea, you naturally become evermore respectful of the earth. And mindful of your place in it.*

*For us, sailing is the ultimate sustainable travel. And it's time for sailboats to live up to that.*

*Living a luxury life and protecting the earth can, and should, go hand in hand.*

*This is why we started Vaan. To build luxury yachts, that do not harm the planet. To restore the balance between pleasure and planet. To enable people to travel to pristine places, without causing negative impact. To protect the beauty of nature and enjoy it at the same time.*

*Sail the Planet!"*

*Nienke van 't Klooster & Igor Kluin*











[www.vaan.yachts](http://www.vaan.yachts) | [contact@vaan.yachts](mailto:contact@vaan.yachts) | +31 85 071 9999

Stationsplein 9 | 3224 AT | Hellevoetsluis | Holland

©2023 Vaan Yachts BV, Holland. All rights reserved.

All black & white photos by Maarten Corbijn ([corbino.nl](http://corbino.nl))

*Disclaimer: This brochure is meant only for promotional purpose and has no legal value. The plans, specifications, images and other details herein are only indicative and subject to change. Vaan reserves the right to change any or all of these designs and specifications without prior notice or obligation. Artists' impressions are used to illustrate the design only. This printed material does not constitute an offer, obligation and/or contract of any type.*

